

**TaiShan**



Gymnastics

(Version 2021)



**BVBA SPORTA DE WAELE**

Gentsesteenweg 190

**9240 ZELE-België/Belgique/Belgium**

Fabriek van sport-, turn- & fitnessstoestellen

☎ 052/44 43 38

✉ [sportadewaele@skynet.be](mailto:sportadewaele@skynet.be)



## COMPANY PROFILE

Shandong Taishan Sports Equipment Co., Ltd. Has a registered capital of 50 million yuan and is located in the Economic and Technological Development Zone of Leling City, Shandong Province. Taishan has branches in Beijing, Shanghai, Shenzhen, Jinan, Xi'an, Chengdu etc. In the United States and Japan we own international affiliates and R&D centers. The main products and services include a full range of competitive sports equipment, all kinds of training equipment, civilian fitness equipment, Hi-tech sports & leisure mats, winter sports products and operation of sports events.

Taishan is a world-known sports equipment manufacturer, with the pioneered CD2S mode (consulting, design, supply and service), Taishan has successfully served several Olympic Games, Youth Olympic Games, Asian Games, Universiade, National Games and many other events, all achieving “Zero Fault, Zero Breakdown, Zero Complaint”. Taishan has grown into a world-renowned sports event equipment supplier and service provider and is called “the miracle in the history of Olympic games” by former president of International Olympics Committee and “National Brand and Chinese Honor” by various circles of the society.

Relying on a number of national-level R&D platforms such as “National Engineering Technology Research Center for Sports Goods”, “National Industrial Design Center”, “National Recognized Enterprise Technology Center”, “Postdoctoral Programme”, Taishan is equipped with national-level research strength and international level testing capability for sports goods. Taishan owns more than 300 patents and is involved in making international and domestic standards for more than 60 terms, and more than 100 products were approved by the IAAF, FIG, IJF, WTF, IWUF, FIFA, FIH and UCI, etc. Taishan's mats are listed in China torch program. Based on technology innovation, Taishan has produces a series of carbon fiber gymnastic equipment, the upgrade of the material is revolutionary, and these equipments are all approved by FIG. At the same time, we continue to popularize gymnastic equipment, develop gymnastic equipment for children and elderly people, realizing “Olympic quality, Enjoyed by all” .

Over the years, Taishan equipment company has maintained good exchanges and cooperation with the IOC, SportAccord, FISU, and associations for international individual sports event. Taishan has already established the premier global strategic partnership with FISU and SportAccord. In the future, under the guidance of “One Belt, One Road” initiative, we will put the best effort to introduce Taishan as a national brand to the world and bring sports enjoyment to the world.

LET THE WORLD ENJOY SPORTS

SPORTS

Qualifications

We have the most of the FIG Certifications in China



Official FIG Partner





Parallel Bars  
08-11



Vaulting Table  
31-34



Artistic Floor  
50-51



Tumble Track  
57-59

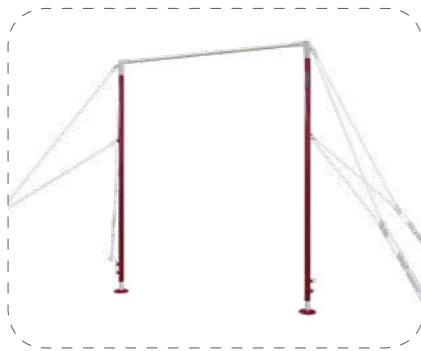

Horizontal Bar  
13-15



Spring Board  
35-36



Rhythmic Floor  
52-53



Auxiliaries  
60-64



Ring Frame  
17-21



Uneven Bars  
38-43



Aerobics Floor  
54



Happy Gymnastics  
65-72

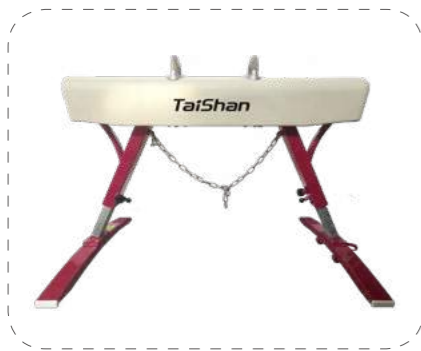

Pommel Horse  
23-29



Balance Beam  
45-48



Trampoline  
55-56

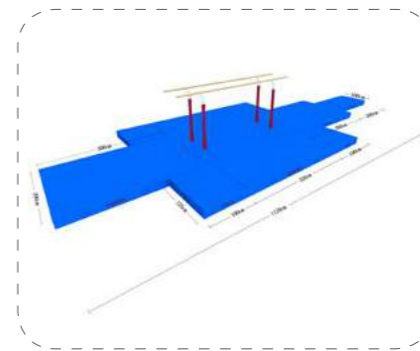

Landing Mats  
73-81

# Parallel Bars



NEW



## Competition Parallel Bar

Model: TQ1001B

1. Bar length: 350cm; bar material: fiberglass with wooden cover; vertical axis length: 5cm; horizontal axis length: 4cm. The improved bar has a Patented built-in safety device which effectively prevents sudden injury and personal injury.
2. Each column is made of two seamless steel pipes riveted together through advanced thermal process to ensure stability.
3. Lifting rod is made of stainless steel, which is resistant to corrosion, with treated surface to ensure the flexibility of the lifting process. Each gear is clearly marked with quick adjustment.
4. The locking device handle adopts plastic-impregnated technology, which is extremely comfortable. The round nut is more secure and stable.
5. The base is welded with high-quality rectangular steel tubes, and the X-shaped design enhances the overall stability.
6. Height is adjustable between 160cm-210cm, with each increment of 5cm, with stepless adjustment between 42cm-62cm, distance between columns is 230cm.

Features: Ensures the safety using the equipment while increasing the bar surface flexibility. Overall stability of the parallel bars is guaranteed. Surface is baking varnish (red, Pantone 1955c).

Advantages: Anti-fracture surface, anticorrosion of metal parts, height and width adjustment can be completed in one step.



### Parallel Bars for Training

Model: TQ2001A

1. Bar length: 350cm; bar material: high quality fiberglass with wooden cover; vertical axis length: 5cm; horizontal axis length: 4cm.
2. Height adjustment scope is 160cm-210cm, with each increment of 5cm. The distance between two bars: 42cm-62cm.

Features: High safety and stability, strong elasticity of the bar surface. Surface is baking varnish (silver). Consists of bars, columns and the base, to ensure its overall stability.



### Parallel Bars for Juvenile Training

Model: TQ2002A

1. Bar length: 270cm; bar material: high quality fiberglass with wooden cover; vertical axis length: 5cm; horizontal axis length: 4cm.
2. Height adjustment scope is 120cm-160cm, with each increment of 5cm. The distance between two bars: 32cm-52cm.

Features: Suitable for juvenile training. Surface is baking varnish (silver). Consists of bars, columns and the base, to ensure its overall stability.

### Rails

Name	Rails for Competition Parallel Bars	Rails for Training Parallel Bars	Rails for Children Parallel Bars
Model	TQ1001B.05	TQ2001.05	TQ2003.03
Specification	Length 350cm	Length 350cm	Length 170cm



### Children Parallel Bars

Model: TQ2003

1. Bar diameter: 4cm; length: 170cm; material: high quality fiberglass with wooden cover.
2. Height adjustment scope is 95cm-135cm, with each increment of 5cm. The distance between two bars is 32cm-52cm and steplessly adjustable.

Features: The column is equipped with special locking and lifting handle, which can quickly adjust the height of bars. The column and base are connected by a special fastening device to guarantee quick adjustment of the distance between the bars. Surface is baking varnish (silver). Consists of bars, columns and the base, to ensure its overall stability.



### Low Parallel Bars

Model: TQ2004

1. Bar length: 270cm; material: high quality fiberglass with wooden cover; vertical axis length: 5cm; horizontal axis length: 4cm.
2. Distance between two bars: 32cm-52cm, adjustable; column vertical distance: 200cm.

Features: The surface of the bars is spray-painted (silver). Consists of bars, column and the base, to ensure its overall stability.



### The Parallel Bars Training Bag

Model	TQ2006	TQ2006/1
Bag Specification	L 160cm W 60cm H 100cm	L 160cm W 60cm H 120cm

Material: The infill is made of environment-friendly material. With increased overall elasticity, it can prevent athletes from getting hurt during training. The blocks are connected with velcro, which makes it very stable.

Features: The square bag has strong elasticity to ensure the stability of the square bag. The column and the base are connected by the special fastening device. The distance between the square bags can be adjusted quickly. The surface of the metal frame is spray-painted (silver).

Consists of bags, columns, base parts, to ensure the overall stability of the parallel bars.



**Parallel Bars Protection Bench**

Model: TQ2047  
 Specification: Bench length is 254.5cm, width is 25.5cm  
 Weight: 34kg  
 Material: High quality red pine with eco-friendly varnished surface.  
 Features: Parallel bars' assistant training equipment, suitable for junior practitioners, equipped with special adjustment locking handle, can quickly and easily adjust the height of the bench. Spray-painted surface (silver).  
 Consists of bench surface ring, regulating tube and lifting frame.



**Parallel Bars Cart**

Model: TQ2048A (match with TQ1001B)  
 Specification: 100cm×100cm×20cm  
 Weight: 7.5kg  
 Features: The overall structure adopts lever principle, which can easily achieve the removing of parallel bars, equipped with high load casters, ensuring its free movement and protection to the floor. Parallel bar transport tool. Frame is spray-painted (silver).



Horizontal Bar



### Competition Horizontal Bar

Model: TQ1002

1. The bar is made of elastic material with diameter of  $\varnothing 2.8\text{cm}$ , and bar length is 240cm.
2. Column is made of  $\varnothing 6\text{cm} \times 0.4\text{cm}$  high-quality seamless steel pipe.
3. Adjusting rod is made of  $\varnothing 5\text{cm} \times 1\text{cm}$  high-quality seamless steel pipe, with specially treated surface to ensure the flexibility during adjusting.
4. Tension cables are made of  $\varnothing 0.6\text{cm}$  stainless steel wire with two Clamping bolt, quick adjustment of cable tension is achieved.
5. Height is adjustable between 270cm-305cm, with each increment of 5cm and special locking system.

Features: The height adjustment is fast and convenient, the locking system is firm and stable, double tension system increases the overall elasticity and stability, the enlarged circles of footholds disperse the pressure from athlete. Used for competition and training. Surface is baking varnish (red, Pantone 1955c).

The overall weight is 80kg. Consists of bar, columns and steel wire.

### Horizontal Bar Rail

Name	Competition Horizontal Bar Rail	Children Horizontal Bar Rail
Mode	TQ1002.01	TQ2003.03
Specification	Length: 240cm $\varnothing 2.8\text{cm}$	Length: 170cm $\varnothing 4\text{cm}$



### Multi-function Horizontal Bar

Model: TQ2007

1. Bar diameter:  $\varnothing 2.8\text{cm}$ ; length: 240cm.
2. Outer casing is equipped with a special locking lift handle, ear plate structure designed to ensure the rapid replacement of rail during training.
3. Tension system is made of  $\varnothing 0.6\text{cm}$  stainless steel wire equipped with rope tightening device to achieve quick adjustment.
4. Height adjustment scope: 90cm-280cm.

Features: Height adjustment is not limited by the rope system; quick and easy adjustment; the base of the foot can sufficiently disperse the maximum impact of athletes.

Consists of 5 parts: bar, columns, base, adjusting tube and tension system, to ensure the overall stability.



### Horizontal Bar Protection Bench

Model: TQ2054

Specification: The support platform is 100cm long and 45cm wide.

Weight: 28kg

Features: With a special adjustment locking handle, it can quickly and easily adjust the height of the support platform. Assistant equipment for horizontal bar practitioners. Frame is spray-painted (silver).

Consists of 4 parts: support platform, lifting pipe, framework and base.



### Counterweight Frame for Competition Horizontal Bar

Model: TQ2009A

Specification: The fixed distance of the wire rope is 400cm $\times$ 550cm; the weight of a single counterweight is not less than 800kg.

Material: The counterweight is made of highquality carbon steel, and the frame is welded.

Features: Suitable for competitions without counterweights, the overall assembly structure, easy to move.





### Horizontal Bar for Kids (A)

Model: TQ2008

Specification: Bar diameter: 4cm; length: 170cm. Height adjustment scope is 155cm-195cm, with each increment of 5cm.

Bar material: High-quality fiberglass with wooden cover.

Features: The column is equipped with special locking lifting handle, which can quickly adjust the bar height. The column and base are connected by a special fastening device that can quickly adjust the bar's position. The surface is spray-painted (silver).

Consists of bar, column, base and adjusting tube, to ensure the overall stability.



### Detachable Children's Horizontal Bar

Model: TQ2008/3

Specification: Bar length 130cm, bar diameter 4cm, the height is adjustable between 95cm and 150cm, and 5cm increments.

Bar material: High-quality fiberglass with wooden cover.

Features: The structure is dismountable, which is convenient for transportation and increases structural stability. The column is equipped with a special locking lifting handle, which can quickly adjust the bar height. The column and the base are connected by a special fastening device to quickly adjust the position of the bar. The surface is spray-painted.

Weight: 45kg

Consisting of four parts: bar, column, base and regulating tube, ensuring the overall stability of the bar.



Ring Frame



### Ring Frame

Model: TQ1006B

1. Height 590 cm, distance between two columns is 316cm and distance between two rings is 50 cm.
  2. Made of composite wood material, the rings have a strong hydroscopicity. Height is adjustable between 275cm-300cm, with increment of 5cm.
  3. The crossbeam is made of high-quality welded 12cm×8cm tube, with special built-in rubber spring device, the absorbing effect is significantly enhanced.
  4. The columns are welded by high-quality 6cm×8cm×0.2cm and 5.5cm×7.5cm×0.2cm square tube, strengthen improved for better stability.
  5. The lifting rod is made of 7.5cm×5.5cm steel tube. With special treatment on tube surface, the lifting flexibility is greatly improved. with increment of 5 cm.
  6. Equipped with φ0.6cm stainless steel cable and 4 tighteners, the tension system can realize the rope tension quickly.
- Features: Attached to the rubber spring system by special steel cable, the rings can be stressed uniformly and then make the buffer action reach an optimal level, to prevent injury of hand joints. The enlarged round foot pad can disperse pressure caused by maximum impact forces, double tension system can strengthen the stability. Surface is baking varnish (red, Pantone1955c).
- Advantages: The ring is anti-fracture, strong sweat and moisture absorption.



### Training Ring

Model: TQ2030

1. Overall height: 590cm; distance between the two columns: 316cm; distance between two ring loops is 50cm.
  2. The ring loop is made of beech plywood with good moisture absorption; ring height adjustment range is 80cm-270cm,5cm increments.
  3. Equipped with a quick adjustment system, only one knob is needed to achieve height adjustment.
- Features: The ring ring is connected to the column by stainless steel wire rope, cowhide ring belt. The two rings are evenly stressed to achieve the best level of cushioning, protect the athlete's hand from injury, and the larger foot pad disperses the maximum pressure brought by the movement, the double tension system enhances the overall stability, and the surface is spray-painted (silver).
- The whole is composed of five parts: a beam, a column, a ring, a rope, and a shock absorbing device.



### Ring Sling and Loop

Model: TQ1006.08 (for TQ1006B)

Material: The ring loop is made of beech plywood, suspended on the shock-absorbing bearing system stainless steel wire rope and cowhide ring strap.



### Wall Ring

Model: TQ2033

1. Arm length: 180cm, rings' distance: 50cm.
2. Rings are made of composite wood with good moisture absorption. Height adjustment scope from rings to the ground is 80cm-270cm, adjustable.

Features: The rings are fastened to fixed device by stainless steel rope, leather and ring straps. The tensioning system strengthens its stability. Surface is spray-painted (silver).

Consist of framework, fixed flange, rings, tension rope and damping device.



### Gymnastics Ring for Kids

Model: TQ2032

1. Ring diameter: 16cm; ring material: composite wood with good moisture absorption.
2. Ring height adjustment is 105cm-135cm, with each increment of 5cm.

Features: The columns are equipped with special lifting locking handles, can adjust the rings height quickly. The columns and base are connected by special clamp devices, which strengthens the stability and safety. Surface is spray-painted (silver).

Consists of crossbar, columns, base and rings, to guarantee its stability.



### Arm Strength Trainer for Ring

Model: TQ2031

Specification: 260cm×60cm×75/125cm,

Size of the sliding board: 70cm×34cm,

Material: Covered with special fiber leather, inner is plywood board and high-load sponge. Equipped with special rolling devices, which make it slide smoothly.

Features: Smooth sliding, flexible height adjustment, and stable standing. Surface is spray-painted (silver).

Consist of sliding platform, framework, lifting tube, columns and ring devices.



### Ring Cross Brace Trainer

Model: TQ2034

Specification: 35cm×18cm

Material: The elastic band adopts nylon rubber, and the wide elastic band is built in the framework. Medium elasticity makes arm touching comfortable; The framework is welded by high-quality carbon steel tube and hooks, equipped with special hanging devices.

Features: The auxiliary exercise equipment of rings, can build up one person's arm and wrist strength effectively, special fastening devices can protect the athletes from hand joint injuries, and hanging devices strengthen the stability. Surface is spray-painted (silver).

Consist of framework, fixed flange, rings, ropes and damping device.



### Ring Protection Bench

Model: TQ2052

Specification: The support platform is 80cm in length and 50cm in width; With a special adjustable locking handle, it can quickly and easily adjust the height of the support platform.

Features: Assistant equipment for ring practitioners. The surface is sprayed with plastic (silver).

Consists of 4 parts: Support platform, lift pipe, framework and base.



### Ring Counterweight bracket

Model: TQ2023A

Specification: Fixed distance of wire rope 400cm×550cm; weight of single counterweight is not less than 800kg.

Material: The counterweight is made of high-quality carbon steel, and the frame is welded with a square tube of 5cm×0.3cm.

Features: Suitable for competitions without counterweights, the overall assembly structure is easy to move.



### Ring Hook

Model: TQ2094

Specification: Length 180cm, φ1.8cm

Material: Stainless steel.

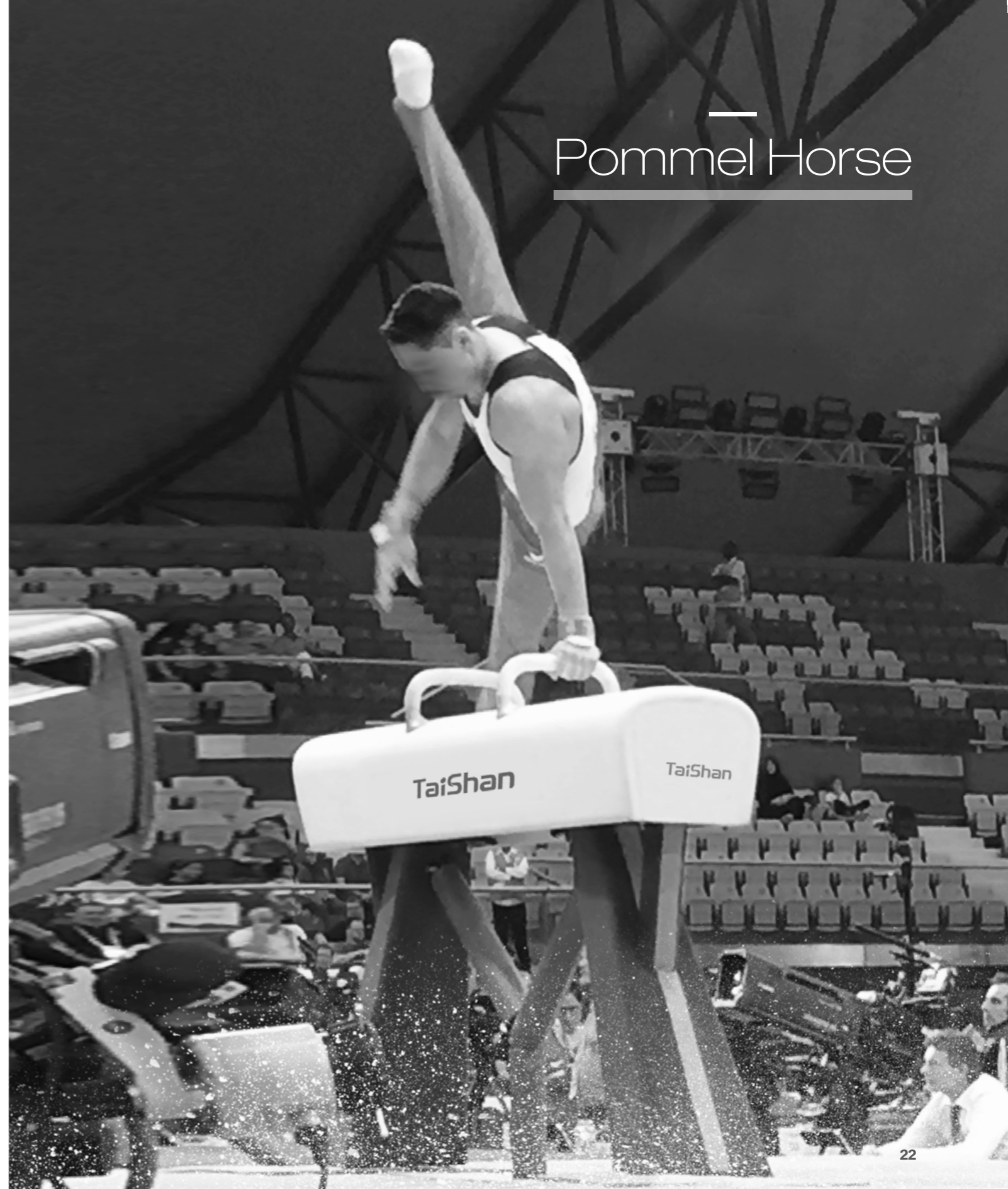

# Pommel Horse

**NEW**



### Competition Pommel Horse

Model: TQ1004B

1. The surface of the pommel horse is covered with a special cowhide. The inner tube is made of wood. It is molded at one time by high temperature molding. The upper part has a high-quality flexible layer. The overall length of the horse is 160cm, the upper width is 35cm, the lower width is 30cm, and the height is 28cm.
2. Columns are welded 7.5cm×12.5cm high quality rectangular tube.
3. Lifting rods are made of 5cm×10cm high quality rectangular tube with treated surface to increase the flexibility.
4. The curved base part is molded with high-quality rectangular tube and equipped with 4 moving wheels.
5. Ring height: 12cm; body height is adjustable between 95cm-125cm with each increment of 5cm.

Features: The special leather used by the new pommel horse increases the frictional resistance, and the change of the horse shape is more conducive to the athletes' performance. It is suitable for professional competition and training. The surface is baked (red, Pantone 1955c).

Weight: 76kg. Consists of rings, body, columns and the base. Protective padding for competition available (optional).



### Pommel Horse Components

Model: TQ1004.02 (for competition Pommel Horse)



### Training Pommel Horse

Model: TQ2024

1. Surface of Pommel horse is covered with special fiber leather, and the built-in body is molded by high temperature molding. Whole length:160cm; upper width: 35cm; bottom width: 30cm; height: 28cm.
  2. Ring height: 12cm; distance between rings:40-45cm, adjustable; overall lifting height of the pommel horse to the ground is adjustable between 95cm-125cm, with each increment of 5cm.
- Features: high load sponge and transverse pressure infill increase shock-absorbing effect, to avoid joint damage of the athletes caused by long-term exercise.

Surface is spray-painted (silver).

Consists of ring, horse body, base and column.



### Low Pommel Horse (A)

Model: TQ2025

1. Pommel horse surface is covered with special fiber leather, and the built-in body is molded by high temperature molding. Whole length:160cm; upper width: 35cm; lower side width: 30cm; height:28cm.
2. The base is multilayer laminated board, with good overall elasticity and stability.
3. Ring height: 12cm; distance between rings: 40-45cm, adjustable; overall height of the pommel horse to the ground: 40cm.

Features: Wooden bow base increases the overall flexibility and stability. The surface is spray-painted (silver).

Consists of rings, horse body and wooden base.



### Low Pommel Horse (B)

Model: TQ2045

1. The horse body is covered with special fiber leather, and the inner part is one-stop molded. The top is adhered with flexible layer. Body length:160cm; top width: 35cm; height: 16cm.

2. Loop distance: 40cm-45cm, continuously adjustable. Lifting height (to the ground): 50cm-65cm, with each increment of 5cm.

Features: Shock absorption is increased by the infill, which can avoid athletes' joint damage caused by long-term training. Equipped with a quick locking adjustment device to realize quick height adjustment. The surface is spray-painted (silver).

Consist of loops, horse body, lifting rod and base.



### Adjustable Mushroom Trainer

Model: TQ2026

1. The surface of the mushroom is coated with special fibrous leather. The mushroom body is shaped by high temperature molding, and the upper part has a flexible layer. Diameter of the mushroom head: 60cm.

2. Mushroom lifting height is adjustable between 50cm-70cm, with each increment of 5cm.

Features: Integrated plastic mushroom head body increases the overall flexibility and stability. Three special feet and one special rubber tuning device effectively protect the floor and can meet any rugged sites. The surface is spray-painted (silver).

Consists of mushrooms head, adjusting pipe and the base.



### Single Ring Mushrooms Trainer

Model: TQ2027

1. The surface of the mushroom is coated with special fiber leather. The mushroom body is shaped by high temperature molding, and the upper part has a flexible layer. The diameter of the mushroom head is 60cm.

2. Pommel ring height is 12cm, mushroom height is adjustable between 50cm-70cm, with each increment of 5cm.

Features: Integrated plastic mushroom body increases the overall flexibility and stability. Three special feet and one special rubber tuning device effectively protect the floor and can meet any rugged sites. The surface is spray-painted (silver).

It consists of mushrooms head, adjusting pipe, base and pommel ring.



### Double Ring Mushrooms Trainer

Model: TQ2028

1. The surface of the mushroom is covered with special fiber leather, the mushroom body is molded by high temperature molding, the upper part has a flexible layer and the diameter of the mushroom is 60cm.

2. Equipped with pommel horse rings, two-ring spacing is adjustable; mushroom height is adjustable between 50cm-70cm, with each increment of 5cm.

Features: Integrated plastic mushroom body increases the overall flexibility and stability. Three special feet and one special rubber tuning device effectively protect the floor and can meet any rugged sites. Surface is spray painted (Silver).

It consists of mushrooms head, adjusting pipe, base and pommel ring.



### Full Rotation Mushrooms Trainer

Model: TQ2029

1. The surface of mushroom is covered with special fiber leather, the mushroom body is high temperature molded, the upper part has a flexible layer and the diameter of the mushroom is 60cm.

2. The rotary table has a specially processed flexible layer, and surface is covered with specialized fiber. Features: Increased rotation platform provides more support area for athletes; one-piece plastic mushroom increases the overall flexibility and stability. Surface is spray-painted (silver).

It consists of mushroom head, rotating platform, column and base.



### Mushrooms Trainer (A)

Model: TQ2050

Material: The surface of the mushroom is coated with special fiber leather, one-step molded The diameter of the mushroom head is 100cm.

Features: Integrally welded base increases the overall stability. Frame is spray-painted (silver).

Consists of mushroom head and base.



### Mushrooms Trainer (B)

Model: TQ2055

1. The surface of mushroom is coated with special fiber leather, and the mushroom head is one-stop molded. The diameter of mushroom head is 60cm.

2. Mushroom head height: 45cm.

Features: The injection-molding mushroom head increases the overall elasticity and stability. Happy gymnastics equipment for children.

Consists of mushroom head, column and base.



### Pommel Horse Moving Balance

Model: TQ2073

1. The whole consists of steel plates, easy for moving and appropriate for field without anchor.

2. Weight: 100kg



### Protection Cover for Pommel Horse

Model: TQ2038 (apply to TQ1004、TQ1004B)

Features: Material with carpet especially for Gymnastics. Colors are selectable.

# Vaulting Table

NEW

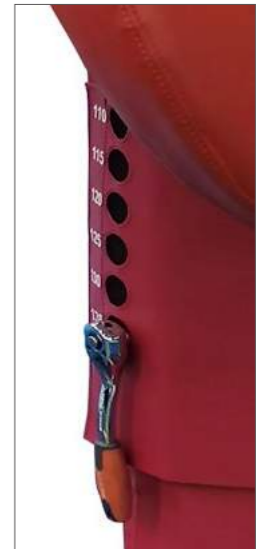

## Vaulting Table

Model: TQ1005B

1. Length: 120cm, width: 95cm. The body is made of fiberglass reinforced composite material, the upper surface is bonded with special shock-absorbing material and wrapped in special material, The performing area and warning area are clearly distinguished.
2. Column is made of 0.5cm high-quality steel tube, with treated surface to ensure flexibility of adjustment. Multifunctional locking device: counter-clockwise rotation to separate inner and outer columns, pulling the safety knob to move the table, and loose it to release automatic locking.
3. Base is welded high quality steel plate, equipped with four special rubber trimmer, to protect the floor and apply to any uneven ground.
4. The overall lifting height is 115cm-135cm, which can be adjusted with each increment of 5cm.

Features: Tongue shaped platform prevents injury, and one-stop molded central column increases overall safety. There are 0.1cm high finetuning devices on each leg to ensure easy leveling adjustment of the 4 legs. Usually adjusting only one leg can realize the whole leveling. Surface is baking varnish (red, Pantone 1955c).

Advantages: One-stop making process increases the overall stiffness, the friction coefficient of the surface is increased, easy absorption of magnesium powder, The flexible layer increases the elasticity, which is conducive to the athletes' performance.





Vaulting Table for Training

Model: TQ2022A

1.Length: 120cm, width: 95cm, Glass fiber molding. The upper layer is bonded with shock absorbing material which has obvious buffering effect. The performing area and warning area are clearly distinguished.

2.The overall lifting height is 110cm-135cm, which can be adjusted with each increment of 5cm.

Features: Tongue shaped platform prevents injury, and central column is one-stop molded. The overall safety is improved, has obvious moisture absorption and anti-slip effect. The metal parts adopt electrostatic spraying technology, standard color is silver but selectable.



U Mat

Model: TQ2540/1

Specification: 120cm×101cm×22/10.8cm

Material: PVC material cover, infill is XPE and sponge.

Features: Good stability, easy for installation, comfort surface, appropriate elasticity. Mainly used for springboard sports protection.

U Mat I

Model: TQ2556

Specification: 140cm×120cm×21/5cm

Material: PVC material cover, XPE infill.

Features: Good stability, easy for installation, comfort surface, appropriate elasticity. Mainly used for springboard sports protection.



Sponge Square Package Used for Vaulting Horse

Model: TQ2523/1

Specification: 130cm×95cm×95cm

Weight: 58kg

Material: XPE infill.

Features: Assisting vaulting training, suitable for starters.



Vaulting Folding Board

Model: TQ2005A

Specification: 440cm×100cm×2.5cm

Material: Composite birch wood, carpet especially for gymnastics; non-skid surface.



Track

Model: TQ1543

Specification: 2500cm×100cm×1.5cm

Material: Made of XPE and carpet by heat-sealing.



Start Marker for Vaulting Table

Model: TQ2095

Specification: 100cm×5cm×5cm

Material: Wooden

Features: With Velcro straps on the bottom.



### Vaulting Table Base Pad

Model: TQ2647A( apply to TQ1005B)  
 Specification: 250/120cm×120cm×17cm  
 Material: PVC material cover, eco-friendly XPE infill.  
 Features: Good stability, easy to assemble, soft surface, appropriate flexibility. Mainly used for competition and training of Vaulting.



### Hand Pad

Model: TQ1561  
 Specification: 120cm×100cm×3cm  
 Material: Horse leather material cover, XPE inner core.  
 Features: Eco-friendly, good stability, easy to install, soft surface, good for bearing.

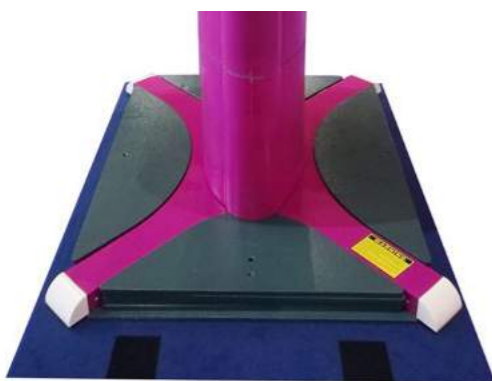

### Vaulting Table Moving Balance

Model: TQ2056  
 1.The whole consists of steel plates, easy for moving and appropriate for field without anchor.  
 2. Weight: 170kg



### Tapeline

Model: TQW0327  
 Specification: 30m long dip stick specialized for vaulting track.

NEW



### Soft Springboard (5 springs)

Model: TQ1010B  
 Specification: 120cm×60cm×22cm  
 Material: Multi-layer fiberglass reinforced composite board covered with grey non-woven carpet, glue 2cm high elastic rubber plastic sponge, of good shock absorption effect. The springboard is precisely positioned by 5 conical springs of different heights, with anti-falling device equipped to the base. The base of the springboard is made of high temperature molding 2cm thick multi-layer birch wood with special anti-skid pad at the bottom.  
 Features: The new springboard increases impact resistance and shock absorption effect. The newly modified anti-skid system is more conducive to the exertion of athletes' difficult performance, suitable for professional competition and training.  
 Advantage: Anti fracture, long service life, convenient for transportation.

NEW



### Hard Springboard (8 springs)

Model: TQ1011B  
 Specification: 120cm×60cm×22cm  
 Material: Multi-layer fiberglass reinforced composite board covered with grey non-woven carpet, glue 2cm high elastic rubber plastic sponge, of good shock absorption effect. The springboard is precisely positioned by 8 conical springs of different heights, with anti-falling device equipped to the base. The base of the springboard is made of high temperature molding 2cm thick multi-layer birch wood with special anti-skid pad at the bottom.  
 Features: The new springboard increases impact resistance and shock absorption effect. The newly modified anti-skid system is more conducive to the exertion of athletes' difficult performance, suitable for professional competition and training.  
 Advantage: Anti fracture, long service life, convenient for transportation.



Soft Springboard (5 springs) for Training

Model: TQ2097

Specifications: 120cm×60cm×23cm

Material: The surface is covered with tufted carpet, equipped with five metal springs, rubber and plastic buffer layer, and the rebound effect is excellent. Color: The standard color is blue.



Hard Springboard (7 springs) for Training

Model: TQ2096

Specifications: 120cm×60cm×23cm

Material: The surface is covered with tufted carpet, equipped with seven metal springs, rubber and plastic buffer layer, and the rebound effect is excellent.

Color: The standard color is blue.



## Uneven Bars



Competition Uneven Bars

Model: TQ1003B

1. Rail diameter 4cm, rail length 240cm, made of high quality fiberglass wrapped by beech veneer.
2. The columns are made of  $\phi 5\text{cm} \times 0.35\text{cm}$  high-quality seamless steel pipe, equipped with special locking&lifting system.
3. The base is made of  $12\text{cm} \times 6\text{cm} \times 0.3\text{cm}$  flat oval high-quality steel pipe, equipped with 4 special rubber pads to increase the friction with the floor.
4. The regulating rod is made of  $\phi 4.2\text{cm} \times 0.8\text{cm}$  high-quality seamless steel tube with special surface treatment, add auxiliary height adjustment handle, which makes the lifting adjustment fast and flexible.
5. The tension system is made of  $\phi 0.6\text{cm}$  stainless wire rope, equipped with 2 quick tensioning blocks, which can adjust the tension of the rope quickly.
6. The height of the low rail is 150cm-200cm, high rail 230cm-280cm, adjustable by each 5cm. The distance between two rails is 110cm-185cm steplessly adjustable.

Features: The rails made by special technology is conducive to the athletes' exertion of difficult performance. Optimize the position of tension ropes to realize the height adjustment of the rails without adjusting the length of the tension ropes and ensuring stability. Add the height adjustment handle and height indication for easy adjustment. Optimize the base, improve the structural rigidity and increase the aesthetics, suitable for professional competition and training. The surface treatment adopts baking paint technology (red, Pantone 1955c).

Composed of rails, columns, base and tension ropes.

Uneven Bars Rails

Name	Rails for Competition Uneven Bars	Rails for Children Uneven Bars
Model	TQ1003B. 01	TQ2003.03
Specification	Length 240cm $\phi 4\text{cm}$	Length 170cm $\phi 4\text{cm}$

Training Uneven Bars (A)



Model: TQ2010

1. Rail diameter 4cm, rail length 240cm, made of high quality fiberglass wrapped by beech veneer.
2. The tension system is made of  $\phi 0.6\text{cm}$  stainless steel wire rope, equipped with 2 quick adjustment devices, make the tension of tension ropes can be finished quickly.
3. The height of the low rail is 135cm-180cm, high rail 205cm-250cm. The distance between two rails is 110cm-185cm steplessly adjustable.

Features: The rails made of special technology is conducive to the athletes' exertion of difficult performance. The special locking&lifting system saves time for height adjustment during training and competition. The wider base increases the overall stability. Powder coating technology is adopted for the surface treatment(silver).

Composed of rails, columns, base, regulating rods and tension ropes.

Training Uneven Bars (B)

Model: TQ2011

1. Rail diameter 4cm, rail length 240cm, made of high quality fiberglass wrapped by beech veneer.
2. The height of the low rail is 135cm-185cm, high rail 205cm-255cm. The distance between two rails is 110cm-185cm steplessly adjustable.

Features: Fix the columns with the connection device of diagonal brace, so that the equipment is not limited by the site and floor hooks. Equipped with movable castor. The wider base increases the overall stability. Powder coating technology is adopted for the surface treatment(silver).

Composed of rails, columns, base, regulating rods and diagonal braces.





### Uneven Bars for Children

Model: TQ2012

1. Bar diameter: 4cm; length: 170cm; material: high quality glass reinforced plastic with wooden cover.
2. Height adjustment of low bar: 95cm-135cm; height adjustment of high bar: 155cm-195cm with each increment of 5cm. The distance between two bars: 32cm-52cm, stepless.

Features: The column is equipped with special locking lifting handle, which can quickly adjust the height of bars. The column and base are connected by a special fastening device that can quickly adjust the distance between the bars. The surface is spray-painted (silver).

Consists of bars, columns and the base, to ensure the overall stability.

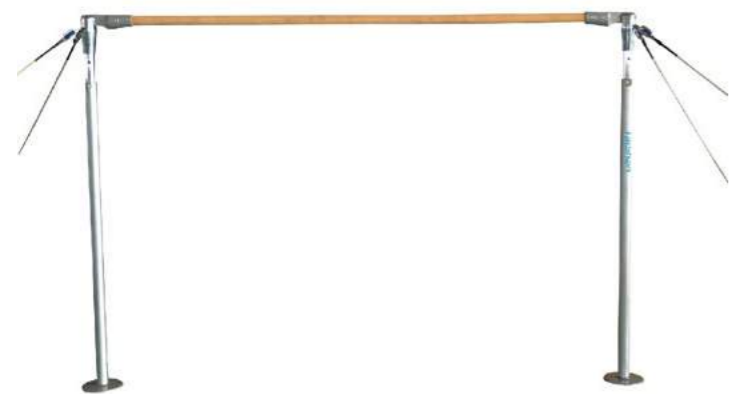

### Horizontal Bar Support (A)

Model: TQ2013

1. Bar diameter: 4cm; length: 240cm; material: high quality glass reinforced plastic with wooden cover.
2. Tension system is made of  $\phi 0.6$ cm stainless steel wire, equipped with quick tightening device to guarantee quick tension adjustment.
3. Height adjustment: 145cm-255cm.

Features: High stability and safety, better rail elasticity, tension system ensures the overall stability of the bar. The surface is spray-painted (silver).

Consists of bar, columns, base, and tension system, to ensure the overall stability.



### Horizontal Bar Support(B)

Model: TQ2014

1. Bar length: 240cm; Bar diameter: 4cm; material: high quality glass reinforced plastic with wooden cover.
2. Larger chassis is equipped with non-slip rubber pad.
3. Height: 40cm.

Features: Larger chassis enhance the overall stability of the equipment. The surface is spray-painted (silver).

Consists of bar, columns and the base, to ensure the overall stability.



### Elastic Handstand Rotation for Training

Model: TQ2015

Specification: Bar length: 170cm; Bar diameter: 4cm. The height of bar is adjustable from 95cm to 135cm, the width of bar between elastics parts is stepless.

Material: High quality glass reinforced plastic with wooden cover. Elastic components are rubber band with high loadbearing sponge, covered with PU leather, bonded by Velcro, with good overall elasticity.

Features: The column is equipped with special locking lifting handle, which can quickly adjust the bar height. The column and base are connected by a special fastening device that can adjust quickly the distance between the elastic parts and the bar. The surface is spray-painted (silver).

Consists of bars, elastic part, columns and the base, ensure the overall stability.



### Uneven Bars Protection Bench

Model: TQ2049

Specification: The platform is 100cm long and 45cm wide. Weight: 30.5kg

Material: The supporting platform surface is covered with special fiber leather. The built-in body is high strength plywood, and the upper part is affixed with high load-bearing sponge. It is equipped with a special adjustment lock handle, which can adjust the height of the support platform quickly and easily.

Features: Special fiber leather ensures moisture absorption. the inside high load-bearing sponge increases shockabsorbing effect and overall comfort. It is suitable for uneven bars junior practitioners. Frame is spray-painted (silver).

Consists of 4 parts: supporting platform, lift pipe, framework and the base.



### Standard Uneven Bars Counterweight Bracket

Model: TQ2018A

Specification: The fixed distance of wire rope is 400cm $\times$ 550cm; the weight of single counterweight is not less than 800kg.

Material: The counterweight is made of high quality carbon steel, and the frame is made of welded square tube 5cm $\times$ 0.3cm.

Features: Suitable for weightless venues. The overall assembly structure makes it easy to move.



### 360° Tossing Bracket

Model: TQ2016

1. Overall height: 640cm; distance between two columns: 240cm; belt lifting height can be adjusted.

2. The leather belt is equipped with a rotating device hanging on the top of the frame by nylon rope.

3. The pull system is made of  $\phi 0.6\text{cm}$  diameter stainless steel rope, which is equipped with quick rope tightening device to guarantee quick rope tensioning.

Features: The leather belt rotating device hanging on the frame top can reach the ground through the pulley, which will protect athletes from getting injuries when doing the movements. The big mat can disperse pressure from movement. The pull system enhances the overall stability. The surface is spray-painted (silver).

It consists of 5 parts: beams, columns, belt parts, base and rope.



### Bar Protection

Model: TQ2756

Specification: Length 140cm, outer diameter 11cm, inner diameter 5cm.

Material: Infill with high load-bearing sponge, surface with PVC warp knitting fabric.

Colors: Customized.



### Bar U Protection

Model: TQ2757

Specification: Length 140cm, height 10cm, inner diameter 5cm.

Material: Infill with high load-bearing sponge, surface with PVC warp knitting fabric.

Features: There are handles on the side part, with it you can pull out the protection quickly and easily.

Applicable for horizontal bar, parallel bar and uneven bar.

Colors: customized.



### Palm Glove

Model: TQW0329

Specifications: Small (Palm length 9-10cm), medium (Palm length 10-11cm), large (Palm length 11-12cm)

Material: Full grain leather.

Features: Anti-slip and wear-resistant, used for wrist and palm protection in gymnastics and horizontal bar exercise.



# Balance Beam

NEW



### Balance Beam

Model: TQ1007B

1. Beam length is 500cm, top width is 10cm, and height is 16cm. Inner tube is made of aluminum alloy material. Adhered with high-density rubber sponge on the top and covered with special fiber leather and hygroscopic material, for better damping effect.
  2. The columns are welded with high-quality steel tubes of 5cm×10cm and 6cm×0.4cm. The 2 oval-shaped special locking systems make it much convenient for the height adjustment.
  3. Height adjustment scope is 70cm-125cm, with each increment of 5cm.
  4. Four trimmers are equipped at the bottom of the supporting leg, which can meet the adjustment needs in different circumstances and increase the stability at the same time.
  5. The elliptical supporting tube is covered with one-step molding sleeve, which is good looking and make it safer to use.
- Advantages: The optimized beam surface is softer and increases the coefficient of friction. The optimized flexible layer is much conducive in absorbing vibrations while ensuring good support. The added fine-tuning of level effectively ensures the level of equipment, which is conducive to the athletes' performance. It is suitable for professional competition and training use. The surface is baking varnish (red, Pantone 1955c).



### Balance Beam for Training

Model: TQ2017A

1. Beam length is 500cm, top width is 10cm, and height is 16cm, covered with special fiber leather and hygroscopic material, with better damping effect.
  2. Height adjustment scope is 70cm-125cm, with each increment of 5cm.
  3. The metal part of the bracket is welded with oval tubes, which is much safe and stable to use.
- Features: Special rubber damping system increases the overall flexibility of the beam, the handle can quickly adjust the height of beam, fast and solid locking, and foam end block to maximize the protection of the athletes from injury. It consists of beam and main legs.



Name	Low Balance Beam (B)	3m Low Balance Beam (B)	2.5m Low Balance Beam (B)
Model	TQ2019	TQ2019/1	TQ2019/2
Beam Length	500cm	300cm	250cm
Upper Width	10cm	10cm	10cm
Height	16cm	16cm	16cm
Overall Height	40cm	40cm	40cm

Features: The beam is covered with special fiber leather and hygroscopic material, with better damping effect. Special rubber damping system increases the overall flexibility of the beam, the plum-shaped handle can adjust the distance between two legs quickly, fast and tight locking, and pre-formed foam end block can maximize the protection of the athletes from injury.

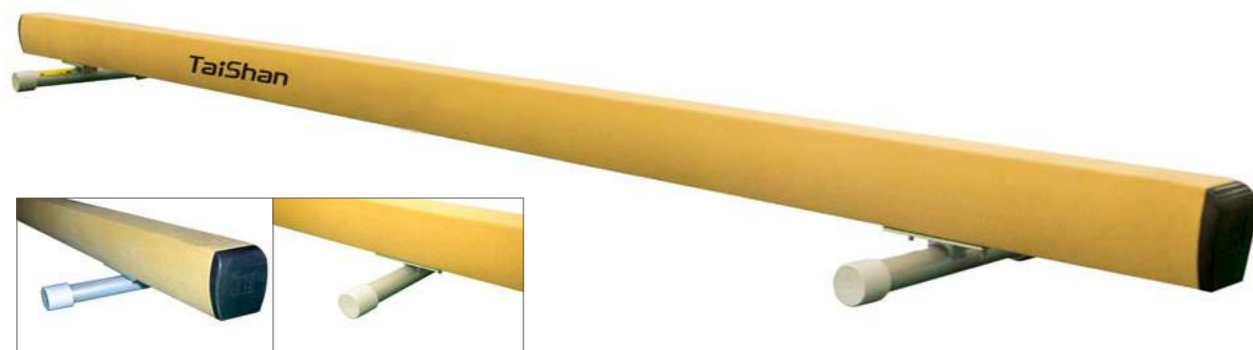

Name	Low Balance beam	3m Low Balance Beam	2.5m Low Balance Beam
Model	TQ2051	TQ2051/1	TQ2051/2
Length	500cm	300cm	250cm
Width	10cm	10cm	10cm
Beam Height	16cm	16cm	16cm
Total Height	25cm	25cm	25cm

Material: The upper end of the infill is stuck with high-density rubber sponge and covered with special fiber leather.  
 Feature: The moisture absorbing surface provides good shock-absorption. special rubber shock-absorption system increases the overall elasticity of horizontal bar, fast and secure locking. Preformed foam end plugs maximize the protection of athletes from injury. Consists of horizontal bar and main frame.



#### Composite Material Balance Beam

Model: TQFCHL001

1. Weight: 28% lighter than current product;
2. Fatigue test: raised from fifty thousand times to one hundred thousand times;
3. Strength: 4 times stronger than the previous product;
4. Processing Technology: Pultrusion modeling form composite material.

#### Soft Pad for Balance Beam

Model: TQ2021

Specification: Widened board length: 250cm, width: 20cm.  
 Material: The top is stuck with high density rubber sponge, coated with special microfiber leather.  
 Features: Special safety belt to be fixed on the balance beam surface, suitable for junior practitioners.



#### Balance Beam Protection Cover

Model: TQ1007B.08 + TQ1007B.09  
 (Suitable for TQ1007B)  
 Material: Leather and high-load sponge  
 Features: It has good stability and flexibility, convenient installation, comfortable cushion surface. It is essential for the competition events hold by FIG.



#### Soft Mat for Balance Beam

Model	TQ2549	TQ2709
Specification	100cm × 50cm × 2cm	120cm × 40cm × 2cm

Features: Good stability, easy to install, soft surface, appropriate flexibility, used with balance beam.



#### Cart for Balance Beam

Model: TQ2079

Features: The balance beam can be easily transferred, equipped with high load industrial casters, not only ensure that the equipment can move freely and to protect the site.



# Artistic Floor



NEW



## Artistic Floor B

Model: TQ1008B-F

1. Whole size is 1410cm×1410cm, competition area is 1200cm×1200cm, Diagonal length is 1697cm, There is a clear distinction between the competition area and the safety area. The surface is a blanket combination and the bottom is connected with a buckle.

2. The flexible layer is 5cm thickness XPE puzzle mat, the bottom has 72 laminate plates precisely according to the installation, 2304 spring composition, the surrounding belt weir, to achieve the best function.

3. Each set of standard site is equipped with multiple H-shaped profiles to connect the bottom plate together, and the tension webbing will lock each bottom plate firmly together, so that the whole site becomes one.

Features: New spring damping system and high quality flexible layer have good cushioning performance, to ensure the best rapid resilience, suitable for professional competition and training use.

**NEW**



### Artistic Floor

Model: TQ1008D

- 1.The surface size is 1400cm×1400cm, the size of the competition area is 1200cm×1200cm, and the diagonal size is 1697cm. The competition area is clearly distinguished from the safety area.
- 2.The flexible layer is composed of EV30 material with a thickness of 6cm, which has obvious shock absorption effect and increased safety.
- 3.The bottom plate is made of 1.3cm high quality birch wood multi-layer board, the surface is made of high quality glass fiber by high temperature molding, and 2304 springs are precisely positioned to achieve the best function.
- 4.Each set of standard site is equipped with multiple i-shaped profiles to connect the bottom plate together, and a tension ribbon to firmly lock each bottom plate together, so that the whole site becomes one.

Features: new spring damping system and high quality flexible layer have good cushioning performance, ensuring the best quick resilience, glass fiber floor to avoid the maximum impact caused by the breaking of wood, toughness and elasticity, suitable for professional competition and training use.The whole consists of spring, substrate, flexible layer (EV30) and blanket surface.

Advantages: High quality tufted carpet, increase the surface comfort.The new flexible layer increases elasticity and is more conducive to the performance of athletes' movements.



### Rhythmic Floor

Model: TQ1009

- 1.Whole Size: 1450cm×1450cm; performance area size: 1300cm×1300cm including 5cm wide demarcation line that distinguishes performance area and safety area. The surface is covered with velvet knitted carpet, with each roll being 1450cm×362cm, a total of 4 rolls. The bottom is connected by strong adhesive tapes.
- 2.The whole structure consists of 2 layers of 0.9cm high-quality plywood, and the upper layer is made up of 100 pieces of 122cm×122cm, 40 pieces of 122cm×61cm and 4 pieces of 61cm×61cm. The lower layer is made up of 121 pieces of 122cm×122cm. 3025 high quality rubber damping blocks are arranged at the bottom of the floor, positioned precisely to achieve the best performance.
- 3.The two boards are equipped with powerful buckle, the upper layer and the lower layer are staggered and fixed together, make the whole venue become one. High load-bearing sponge together with floor edge make the protected area more secure.

Features: special foam vibration absorption effect is obvious; good cushion performance, anti-static and non-slip surface layer of the blanket help athletes to perform high difficulty movements. The whole body is composed of three parts: the bottom plate, the surface blanket, the highload bearing sponge edge floor.

Weight: 2600kg. With optional sizes.

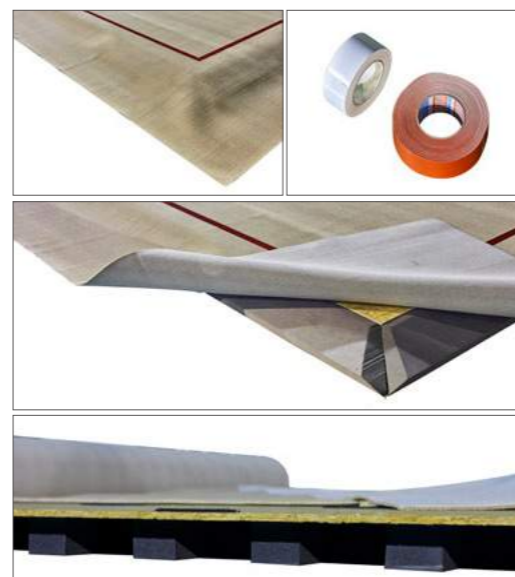



Rhythmic Gymnastics Ribbon

Model: TQW0115 (Competition)  
TQW0115A (Training)  
Material: Ribbon and pole are made of FRP, the handle is made of pvc material.



Rhythmic Gymnastics Stick

Model: TQW0114 (Competition)  
TQW0114A (Training)  
Material: PP



Rhythmic Gymnastics Hoop

Model: TQW0116 (Competition)  
TQW0116A (Training)  
Specification: φ80cm  
Material: Environmental protection PE



Rhythmic Gymnastics Rope

Model: TQW0117 (Competition)  
TQW0117A (Training)  
Material: Fine cotton and linen, length 3m



Rhythmic Gymnastics Ball

Model: TQW0118 (Competition)  
TQW0118A (Training)  
Specifications: φ18cm  
Weight: 0.4kg  
Material: Rubber and plastic



Rhythmic Gymnastics Measuring Table

Model: TQ2098  
Specifications: 105cm×105cm×90cm  
Features: 1 electronic balance with 1g accuracy.  
The whole wooden surface is painted with high-grade environmental protection paint.



Aerobics Floor

Model: TQ1170

1. The sports area is square, the overall size is 1200cm×1200cm, the size of single area is 700cm×700cm, the size of double and triple area is 1000cm×1000cm (The black matt regular line is part of the competition area).
2. The whole is composed of 100 high-density parquet floors. The height is 7.5cm. Each wooden floor measures 120cm×120cm. There are slightly color difference between each wooden unit, which will not have effect on performance.
3. The bottom is provided with a quick rebounding shock absorbing material, which provides a good shock absorbing function for the venue (protecting the user's moving parts). The special tensioning system makes the entire site firmly connected without noise and gaps. Suitable for professional competitions and training.



Aerobics Pedals

Model: TQ1014

Specifications: Trapezoid, 88.5cm in length on the top, 27.5cm in width, 97cm in length in the bottom, 37cm in width, 15cm in overall height.  
Weight: 5.1kg  
Features: The table made of carbon fiber material, smooth appearance and high strength, not easy to deform. It is covered with a special material anti-skid layer and shock absorption layer, noise-free. Effectively protected the bottom plate.

### Standard Trampoline



Model: TQ1013

1. The main bed frame is welded by a special oval tube of 6.5cm×3.5cm, the size is 520cm×305cm×115cm.
2. The mesh size is 426cm×213cm and the material is nylon.
3. The spring part is 8 large springs and 110 middle springs. The size of the large spring is  $\phi 3.9\text{cm} \times 25.8\text{cm}$  and the size of the middle spring is  $\phi 2.9\text{cm} \times 25.8\text{cm}$ .
4. The spring part is equipped with a special protective pad. The material is high elastic sponge covered with PVC surface, with a fixed tension system at the bottom to avoid contact with the spring and increase elasticity.
5. The size of the auxiliary bed is 175cm×260cm×115cm. The mesh surface is made of polypropylene, one pair per set.
6. Suitable for professional competition and training.



### Tumbling Board

Model: TQ2046

1. The overall size is 1200cm×200cm×20cm .
2. The surface layer is covered with XPE for the gymnastics, which increases the overall elasticity. The thickness of XPE is 5cm and the thickness of the special blanket is 2.5cm.
3. The shock absorption system is composed of 280 high-quality springs.



### Children Long Trampoline

Model: TQ2036

Specification: Width: 210cm; height: 56cm, length: 500cm/600cm; 200cm/unit, 78kg/per unit. customized size available.

Material: The lower base is welded with high-quality carbon steel pipes and equipped with floor protection feet.

Weight: Each unit is 200cm long and can be infinitely extended. The weight of 200cm is 78kg.

Features: It adopts a splicing unit module structure, the length can be assembled according to the size of the site, the beam and the base adopt a splicing structure, which is easy to install. The mesh surface is sewn from black nylon mesh and PVC woven fabric. It is equipped with high-strength tensile springs, good elasticity, high stability, and the surface is sprayed with plastic (silver).

Consists of beam, base, tensile spring and mesh surface.



### Inflatable Gymnastics Mat

Model: TQW038

Specification: Customizable

Features: Adopting imported special PVC mesh fabric, using advanced heat sealing and pasting technology, abrasion and flame retardant, good resistance to tearing and drop, good environmental protection and novel appearance. With high- power air pump, fast inflation and long service life.

Remark: When using, make sure that the ground is flat and free of sharp objects, and keep the power supply unblocked. When cleaning, you can use a soft cloth to wipe with detergent.



### Tumble Track

Model: TQ1012

1. The run-up area is 1100 cm in length and is composed of a high-quality composite multilayer birch board and a metal stand.
2. The tumbling area is 2500cm, which is connected by 20 independent units. The elastic part of each unit is connected by 13 pcs of 4cm×2.5cm high-quality fiberglass tubes. The bottom is equipped with a metal bracket and a special rubber buffer device is built in. No noise.
3. The landing area is 300cm×600cm and consists of three 30cm floor mats.
4. The flexible layer is a 6cm XPE foam sponge, the cover layer is a nylon non-woven carpet for gymnastics, and the XPE foam sponge is heat-sealed. The total length is 3600cm.

Features: The special nylon non-woven carpet has good anti-slip performance. The rectangular fiberglass tube increases the resilience, and it is noiseless and stable. The whole is composed of three parts: run-up area, tumbling area and landing area. The metal parts are silver, and the overlay and floor mats are blue.



### Gymnastics High Platform

Model: TQ1016

Specification: Horizontal bar, Uneven bar combination platform is 1800cm×900cm; artistic floor platform is 1800cm×1800cm. balance beam, Pommel horse and ring combination platform is 1800cm×900cm; parallel bars, vaulting horse combination platform is 5400cm×1350cm (special shape).

Material: Multilayer board, high quality metal rectangular tube.

Features: Adopt independent unit structure, good structure, convenient folding and assembly, minimized packaging volume, this product has obtained national patent.

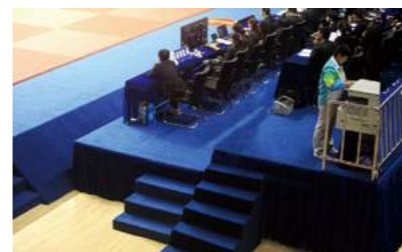

### Referee

Model: TQ1270/2

Specification: 3000cm×400cm×60/80cm (double layer)

Material: Multilayer board, high-quality metal rectangular tube, stainless steel guardrail.

Features: Stable structure and easy disassembly.



### Side Referee

Model: TQ1270/3

Specification: 160cm×122cm×30cm

Material: Multilayer board, high-quality metal rectangular tube.

Features: Stable structure and easy disassembly.



### Foam Pit

Model: TQ2713

Specification: Customizable

Bottom structure: XPE thermally synthesized honeycomb structure is used on the bottom layer, and a whole XPE is laid on the XPE, to increase the vacuum function.

Features: Convenient installation, safe and easy to clean. When using gymnastics equipment, this sponge pit can effectively absorb the magnesium powder, which will prevent the athletes from being hurt.

### Underground Embedded Parts

Model: TQ2069

Specification: 22cm×22cm×12cm (adjustable with the board)

Features: Suitable for wood flooring. The embedded parts are under the wood floor and fixed with expansion screws. A single embedded part can withstand 8000N force without breaking. Installing a cover when not in use ensures that the wooden floor is flush.



### Ground Embedded Parts

Model: TQ2070

Specification: 22cm×22cm×8cm

Features: Suitable for cement floor, embedded parts on the ground, fixed with expansion screws. A single embedded part can withstand 8000N force without breaking.



### Big Vaulting Buck

Model: TQ2091

Specification: The goat is 60cm long, 35cm wide, 28cm high, and the overall lifting height is 100cm-140cm.

Material: The surface of the sheep body is covered with a special fiber leather, and the built-in body is molded at one time.

Features: Jump assist training equipment. Surface is spray-coated (Silver).

The whole is composed of a goat body, a riser and a base.



### Small Vaulting Buck

Model: TQ2090

Specifications: Goat body is 50cm long, 35cm wide, 28cm high, height adjustment range: 80cm-110cm adjustable, lifting distance is 5cm.

Weight: 26kg

Material: The surface of the goat body is covered with special fiber leather, and the built-in body is molded at one time.

Features: Equipped with a special adjustable locking handle, which can quickly and easily adjust the goat's lifting height.

The surface is spray-painted (silver). The whole is composed of a goat body, a riser and a base.



### New Type Vaulting Buck

Model: TQ2035

Specification: 50cm×35cm×28cm, the height of the whole body is 80cm-110cm, and the lifting distance is 5cm.

Material: The surface of the goat body is made of special fiber leather and molded once. The upper part is covered with a high water-borne sponge. It is equipped with 4 special trimmers, which effectively protects the floor and meets any uneven surface.

Features: The welded base of the oval tube effectively increases the overall security, and the surface is sprayed with plastic (silver).

It consists of a goat head, a column, a base.





### 5 Section Vaulting Box

Model: TQ2077

1. The upper surface is covered with a special fiber leather, the built-in body is pine wood board, and the upper part is EVA glued. The dimensions are 125cm in length × 78cm in width × 125cm in height.

2. The vaulting box is divided into 5 sections, and the frame of each section adopts woodworking tenon technology, and the whole connection is firm.

Features: High-load-bearing inner tube increases shock absorption and overall comfort. Environmental spray varnish.



### 7 Section Vaulting Box

Model: TQ2053

1. The upper end surface is covered with special fiber leather, the built-in body is pine board, and the upper part is covered with EVA. The external dimensions are 130cm×78cm×125cm.

2. The jumping box is divided into 7 sections, and the frame of each section adopts woodworking tenon technology, and the whole connection is firm.

Features: High-load bearing inner tube increases shock absorption effect and overall comfort, and the surface is sprayed with eco-friendly varnish.



### Wall Bar

Model: TQ2059

Specification: 90cm×18cm×280cm

Material: Made of Pine wood and Manchurian ash wood through mortise and tenon processes, the whole connection is stable.

Features: Surface is sprayed with eco-friendly varnish.



### Double Wall Bar

Model: TQ2084

Specification: 180cm×18cm×280cm

Material: Made of Pine wood and Manchurian ash wood through mortise and tenon processes, the whole connection is stable.

Features: Surface is sprayed with eco-friendly varnish.



### Parallel Handstand Bars

Model: TQ2057  
 Specification: 40cm×23cm×13cm  
 Material: Made of Pine wood and Manchurian ash wood through mortise and tenon processes, the whole connection is stable.  
 Features: Surface is sprayed with eco-friendly varnish.



### Horizontal Bar Handstand

Model: TQ2058  
 Specification: 90cm×23cm×13cm  
 Weight: 1.5kg  
 Material: Made of Pine wood and Manchurian ash wood through mortise and tenon processes, the whole connection is stable.  
 Features: Surface is sprayed with eco-friendly varnish.



### Wooden Gymnastics Bench

Model: TQ2042  
 Specification: 244cm×25cm×25cm  
 Material: Made of Birch wood, this multi-layered board.  
 Feature: Anti-slip rubber covering on each leg. Lightweight for easy and convenient moving. Narrow bottom board can be used for balance beam exercise when turned over. Surface is sprayed with ecofriendly varnish.



### Magnesium Holder for Hands

Model: TQW0049  
 Specification: 90cm  
 Material: The bottom seat is stamped and formed from a highquality metal plate. The powder box body is molded by glass fiber reinforced plastic at high temperature. It is characterized by high strength, not easy to break, and easy to move.

Magnesium Powder		
Model	TQW0048	TQW0048/1
Material	Standard Block 15kg/box	Pieces 10kg/box



### Magnesium Holder for Feet

Model: TQ2267  
 Specifications: 45cm×45cm×5cm  
 Features: Used for placing magnesium powder, used by athletes to wipe the bottom of the feet, to prevent slipping.



### Gymnastics Court Pad

Model: TQ2043  
 Specifications: Each unit is 200cm in length,135cm in height, and 4cm in thickness.  
 Features: It adopts a splicing unit module structure. The unit modules are connected by aluminum alloy profiles. The assembly structure is convenient for disassembly and assembly. The length can be assembled according to the size of the site. Inlaid PVC high density waterproof board.



### Children Gymnastic Equipment Combination A



Model: TQ2060  
 Specifications: 480cm×480cm×155cm  
 Weight: 193kg (excluding mats)  
 Features: The overall layout of the equipment is reasonable and the installation stability is high. It is mainly used for children's entertainment and exercise children's physical fitness.

### Children Gymnastic Equipment Combination B



Model: TQ2061  
 Specifications: 720cm×350cm×155cm  
 Weight: 205kg  
 Features: The overall layout of the equipment is reasonable and the installation stability is high. It is mainly used for children's entertainment and exercise children's physical fitness.

### Happy Gymnastics Parallel Bars



Model: TQ2085  
 1. Bar face  $\phi$ 4cm, bar length 170cm, the material is high-quality FRP coated wood.  
 2. The lifting height is adjustable between 95cm-135cm, the lifting distance is 5cm, and the width is steplessly adjustable between 32cm-52cm.  
 Features: The column is equipped with a special locking lifting handle, which can quickly and quickly adjust the height of the lever surface. The column and the base are connected by a special fastening device to quickly adjust the distance between the lever surfaces. Surface is spray-painted (red).



### Happy Gymnastics Uneven Bars



Model: TQ2086  
 1. Bar diameter  $\phi$ 4cm, bar length 170cm, the material is high-quality glass fiber reinforced plastic coated wood sheet.  
 2. The lifting height of the low bar is adjustable between 95cm-135cm, the lifting height of the high bar is 155cm-195cm, the lifting distance is 5cm, and the width is steplessly adjustable between 32cm-52cm.  
 Features: The column is equipped with a special locking lifting handle, which can quickly and quickly adjust the height of the lever surface. The column and the base are connected by a special fastening device to quickly adjust the distance between the lever surfaces. Surface is spray-painted (red).



### Happy Gymnastic Horizontal Bar

Model: TQ2083

1. Bar face  $\phi 4\text{cm}$ , bar length 170cm, made of high-quality glass fiber reinforced plastic coated wood sheet.
  2. The lifting height is adjustable between 155cm-195cm, and the lifting distance is 5cm.
- Features: Ensure the safety of the equipment, increase the elasticity of the bar surface, and ensure the overall stability of the horizontal bar, and the surface is sprayed with plastic (red).



### Children Climbing Pad

Model: TQ2041

Specifications: 180cm×180cm×100cm  
Weight: 45kg

1. The climbing board is fixed by 14 different climbing poles with lock nuts and wooden boards according to certain rules; the climbing board is made of high-quality PVC warp knitted fabric, and the inner tube is XPE and special plywood. Adopting special technology for bonding.
  2. The climbing board is connected to the bar surface by a hook and loop fastening device, which is used with children's gymnastic equipment.
- Features: This product has good stability, easy installation, comfortable cushion surface, suitable elasticity, suitable for children to climb. Mainly used for children's entertainment, exercise children's physical fitness. Composed of four parts: climbing board, lifting rod, bracket and base, ensuring the overall stability of the equipment.



### Happy Gymnastic Rings

Model: TQ2087

1. Ring  $\phi 16\text{cm}$ , the material of the ring is composite wood, which is strong in moisture absorption and water absorption.
  2. The lifting height is adjustable between 105cm-135cm, and the lifting distance is 5cm.
- Features: The two rings are evenly stressed to achieve the best buffering effect, protect children's hand joints from injury, stable structure, and the surface is sprayed with plastic (red).



### Children Crawling Net

Model: TQ2040

Specifications: 180cm×180cm×95cm  
Weight: 60kg

1. Crawl net: Staggered by 50 seat belts; Children's crawlers are covered with high-quality PVC warp knitted fabric; Inner tube is XPE and special plywood adopts special process Bonded.
  2. The bracket is integrally welded and formed, and it is connected by special fastening devices, which can be used with children's gymnastic equipment to quickly adjust the mesh tension.
  3. The lifting rod is made of special materials, and the surface is specially treated to ensure the flexibility and rapid adjustment of the lifting process.
- Features: This product has good stability, easy installation, comfortable cushion surface, suitable elasticity, suitable for children to climb. Mainly used for children's entertainment, exercise children's physical fitness. It consists of four parts: the bracket, the lifting rod, the base and the net, which ensures the overall stability of the equipment.



### Children Gymnastic Wrapping Column

Model: TQ4588  
 Specifications: Length: 70cm; outer diameter:  $\phi$ 13cm; inner diameter:  $\phi$ 8cm.  
 Material: The inner tube is made of high-bearing sponge, and the outer cover is made of PU leather.  
 Features: The appearance is beautiful and elegant, it is used with happy children's gymnastic equipment, and the inner tube is suitable for elasticity, which can play a good protective role during sports and exercise.



### Children Gymnastic Wrapping Base

Model: TQ4794  
 Specifications: 220cm $\times$ 40cm $\times$ 20cm  
 Material: The inner tube is made of XPE and sponge, and the outer cover is made of high-quality PVC warp knitted fabric.  
 Features: The inner tube structure has moderate elasticity and is used in conjunction with happy children's gymnastic equipment. It is placed on the bottom of the equipment to effectively avoid injuries during exercise and play a good protective role.



### Handle

Model: TQ4911  
 Specifications: Outer diameter:  $\phi$ 13cm; inner diameter:  $\phi$ 8.5cm; thickness: 1cm.  
 Material: The inner tube is made of high-quality sponge, and the outer cover is made of PU cloth.  
 Features: Placed on the equipment regulating valve, with tightening rope. Decrease between hand and valve during valve adjustment. Friction to facilitate better adjustment of equipment.



### Children's Square Trampoline II

Model: TQ2078  
 1. The main frame of the trampoline is 270cm $\times$ 270cm in size and adopts a cannula structure. The overall assembly is simple and convenient.  
 2. The mesh size is 210cm $\times$ 210cm. Mesh surface is made of black nylon mesh and PVC woven fabric.  
 3. The fence is made of nylon chain link fence with a height of 210cm.  
 Features: The main frame is welded by round pipes, with high overall safety performance. The base is equipped with floor protection feet, which can effectively reduce the damage to the site. The mesh surface is sewn from black nylon mesh and PVC woven fabric, with high strength. Tension spring, good overall flexibility, high stability, children's happy gymnastic equipment. The surface is spray-painted (red). The whole is composed of a main frame, a base, a tension spring and a mesh surface.

### Children's Square Trampoline

Model: TQ2037  
 1. Trampoline main frame size 130cm $\times$ 130cm, welded with carbon oval tube;  
 2. Mesh size 70cm $\times$ 70cm, material is nylon braid;  
 3. Equipped with quick-adjusting locking device, overall The height is 52.5cm to 67cm adjustable;  
 4. The lifting rod adopts a carbon round tube of  $\phi$ 3.2cm $\times$ 0.3cm, and the surface is specially treated to ensure the flexibility and rapid adjustment of the lifting process.  
 Features: The main frame is welded with elliptical tubes, with high overall safety performance, equipped with floor protection feet, which can effectively reduce damage to the site. The mesh surface is sewn with nylon braided belt, equipped with high-strength tensile springs, and overall elasticity. Good, high stability, the surface adopts plastic spraying process (silver). Weight: 30kg.  
 The whole trampoline is composed of four parts: the main frame, the base, the tension spring and the mesh surface.





### Children's Round Trampoline

Model: TQ2082  
 Specifications: Trampoline main frame  $\phi 158\text{cm}$ , 43cm high.  
 Features: The main frame is welded and integrated, high overall safety performance, the base is equipped with floor protection feet, which can effectively reduce the damage to the venue, the net surface is black nylon mesh and PVC The woven cloth is sewn and equipped with high-strength tensile spring, which has good overall elasticity and high stability.  
 The surface is spray-painted (silver).  
 The whole trampoline is composed of three parts: the main frame, the tension spring and the mesh surface.



### Children's Hexagon Trampoline

Model: TQ2081  
 Specifications: Trampoline main frame with an outer circle of  $\phi 160\text{cm}$ , 43cm high.  
 Features: The main frame is welded and integrated, with high overall safety performance, and the base is equipped with floor protection feet, which can effectively reduce the damage to the venue. Sewn with PVC woven cloth, equipped with high-strength tensile spring, with good overall elasticity and high stability.  
 The surface is spray-coated (silver).  
 The whole is composed of three parts: the main frame, the tension spring and the mesh surface.



### Children's Springboard

Model: TQ2044  
 Specifications:  $76\text{cm} \times 57\text{cm} \times 16\text{cm}$   
 Features: Strong overall elasticity, high stability, high non-slip performance, specially designed for gymnastic beginners, suitable for children's practice.



Happy Children Balance Beam  
 Model: TQ2577



Happy Children Gymnastics Vaulting Box  
 Model: TQ2579



Happy Children Colorful Folding Pad  
 Model: TQ4779



Happy Children Obstacle Frame  
 Model: TQ4873



Child Climbing Net  
 Model: TQ2041



Happy Children's Soft Gymnastics Combination  
 Model: TQ4874

Happy Children Gymnastic Ball  
 Model: TQ4526  
 Specification:  $\phi 92\text{cm} \times \phi 50\text{cm} \times 92\text{cm}$

Gymnastics protection mat consists of two types, competition type and training type. The materials of competition type are PVC warp knitting cloth, compressed sponge and XPE; materials of training type are PVC warp knitting cloth, sponge and XPE. The standard color of the mat is blue and customized color is acceptable.

Features of competition-type protection mat: the cover is made of premium PVC warp knitting cloth, it's easy to eliminate air from the holes that designed on the four sides, the lifting handles at the bottom makes it easy to move. With symmetrical structure of XPE and sponge layers inside. All the mats are stucked together with velcro fastening. With good stability, easy installation, comfortable surface, proper elasticity and international standards.

Features of training-type protection mat: made of premium PVC, sponge and XPE. The inner layer is stucked with XPE and sponge. All the mats are stucked together with velcro fastening. it's easy to eliminate air from the holes that designed on the four sides, the lifting handles at the bottom makes it easy to move. With good stability, easy installation, comfortable surface, proper elasticity.

Landing Mats for Pommel Horse (competition type)



Model: TQ1504A  
 Specification: 400cm×400cm×10cm  
 Unit size and quantity:  
 400cm×200cm×10cm (2pcs)  
 Total area: 16 m<sup>2</sup>



Landing Mats for Parallel Bars (competition type)



Model: TQ1510B  
 (compatible for TQ1001B)  
 Specification: 1120cm×450cm×20cm  
 Unit size and quantity:  
 200cm×300cm×20cm (2pcs)  
 100cm×125cm×20cm (4pcs)  
 320cm×70cm×20cm (1pcs)  
 190cm×320cm×20cm (2pcs)  
 200cm×100cm×20cm (1pcs)  
 Total area: 33.4 m<sup>2</sup>

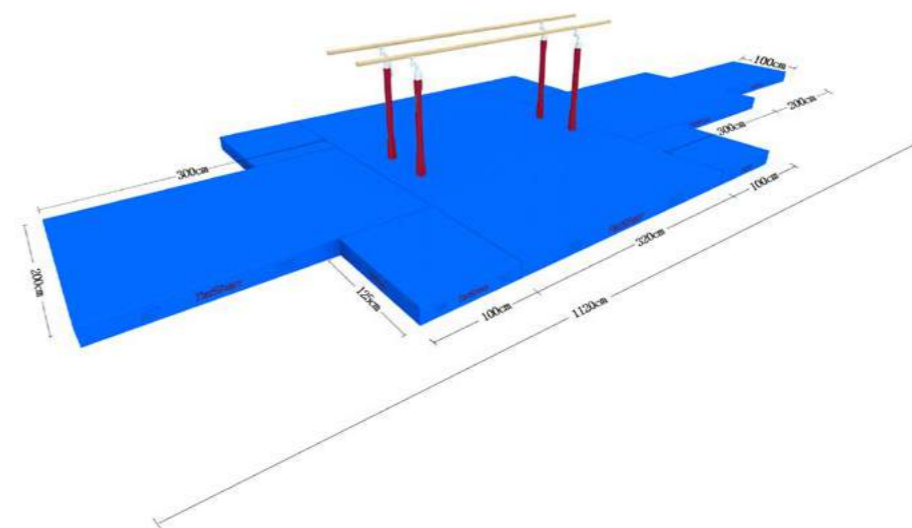

Landing Mats for Parallel Bars (training type)

Model: TQ1509A  
 Specification: 1200cm×600cm×20cm  
 Unit size and quantity:  
 200cm×400cm×20cm (1pcs)  
 300cm×190cm×40cm (2pcs, foldable)  
 220cm×265cm×20cm (2pcs)  
 247cm×69cm×10cm (1pcs)  
 212cm×41cm×10cm (1pcs)  
 200cm×200cm×20cm (1pcs)  
 Total area: 48 m<sup>2</sup>

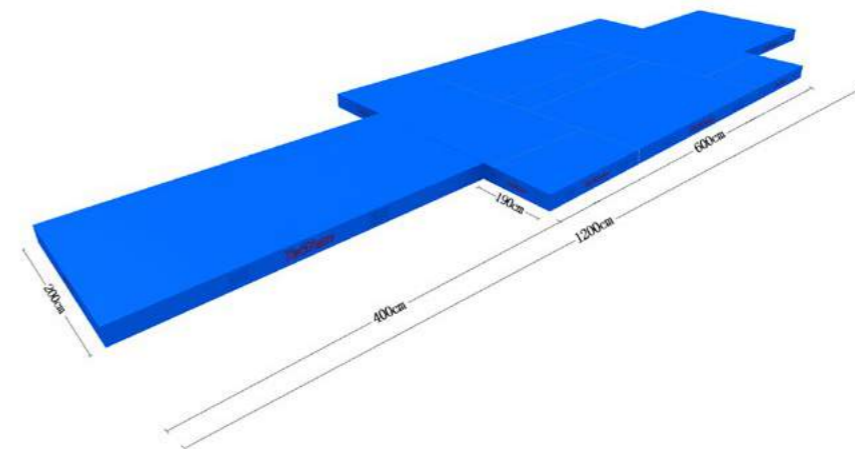

Landing Mats for Horizontal Bar  
(competition type)



Model: TQ1511A  
 Specification: 1200cm×300cm×20cm  
 Unit size and quantity:  
 300cm×200cm×20cm (6pcs)  
 Total area: 36 m<sup>2</sup>



Landing Mats for Horizontal Bar  
(training type)

Model: TQ1502A  
 Specification: 1200cm×200cm×20cm  
 Unit size and quantity:  
 300cm×200cm×20cm (4pcs)  
 Total area: 24 m<sup>2</sup>

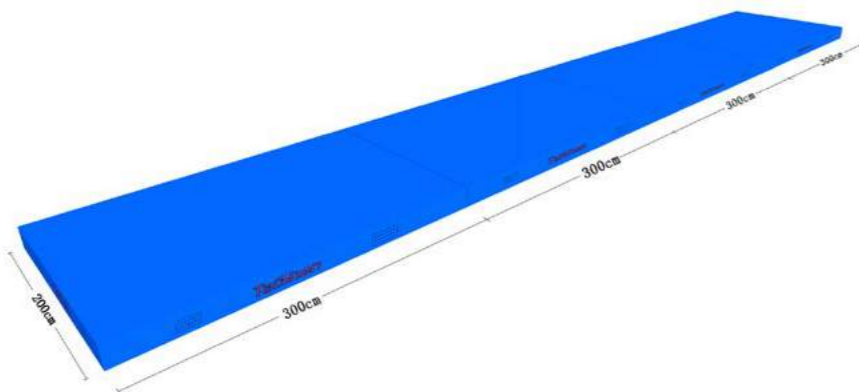

Landing Mats for Rings  
(competition type)



Model: TQ1514A  
 Specification: 500cm×200cm×20cm  
 Unit size and quantity:  
 300cm×200cm×20cm (1pcs)  
 200cm×100cm×20cm (2pcs)  
 Total area: 10 m<sup>2</sup>



Landing Mats for Rings  
(training type)

Model: TQ1506A  
 Specification: 600cm×200cm×20cm  
 Unit size and quantity:  
 300cm×200cm×20cm (1pcs)  
 200cm×150cm×20cm (2pcs)  
 Total area: 12 m<sup>2</sup>

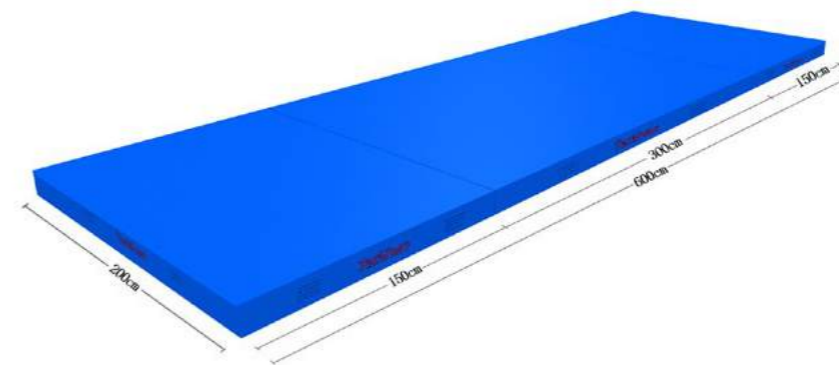

Landing Mats for Vaulting Table  
(competition type)



Model: TQ1513A  
 Specification: 600cm×250cm×20cm  
 Unit size and quantity:  
 200cm×250cm×20cm (2pcs)  
 100cm×250cm×20cm (2pcs)  
 Total area: 15 m<sup>2</sup>

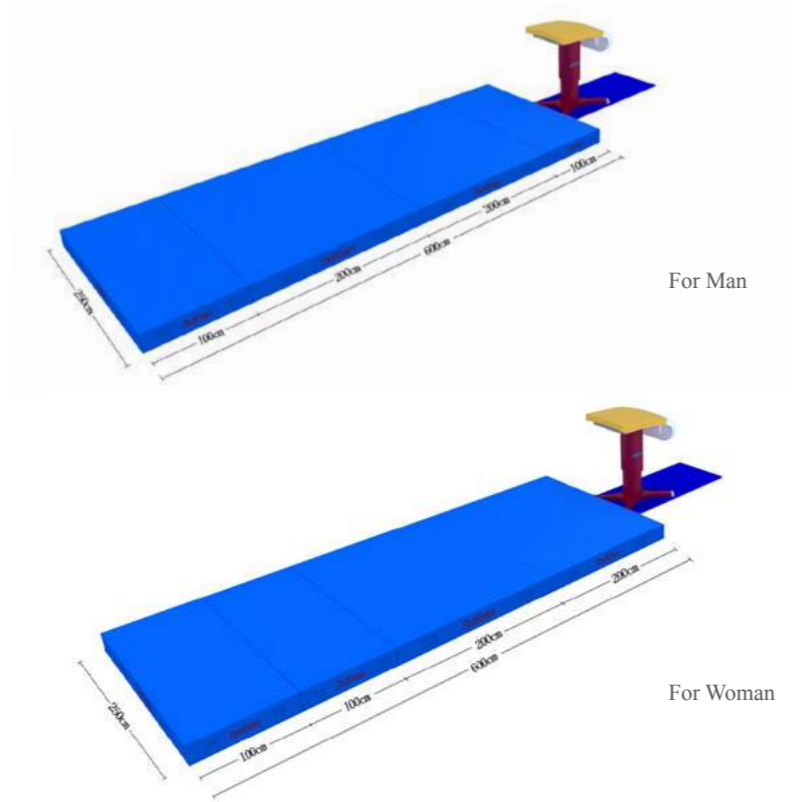

Landing Mats for Vaulting Table  
(training type)

Model: TQ1505A  
 Specification: 800cm×300cm×20cm  
 Unit size and quantity:  
 300cm×200cm×20cm (4pcs)  
 Total area: 24 m<sup>2</sup>

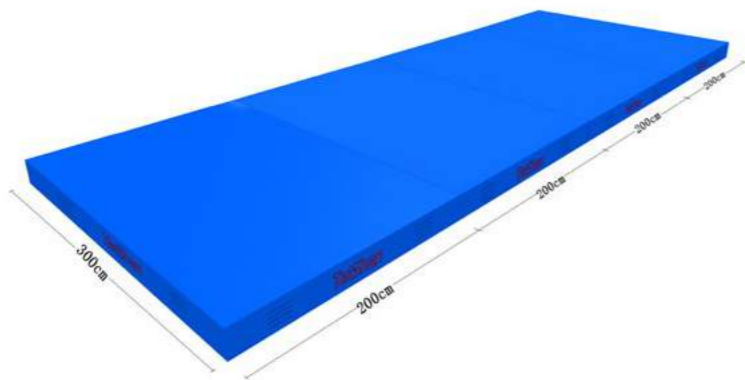

Landing Mats for Uneven Bars  
(competition type)



Model: TQ1512A  
 Specification: 1400cm×200cm×20cm  
 Unit size and quantity:  
 300cm×200cm×20cm (4pcs)  
 200cm×200cm×20cm (1pcs)  
 Total area: 28 m<sup>2</sup>

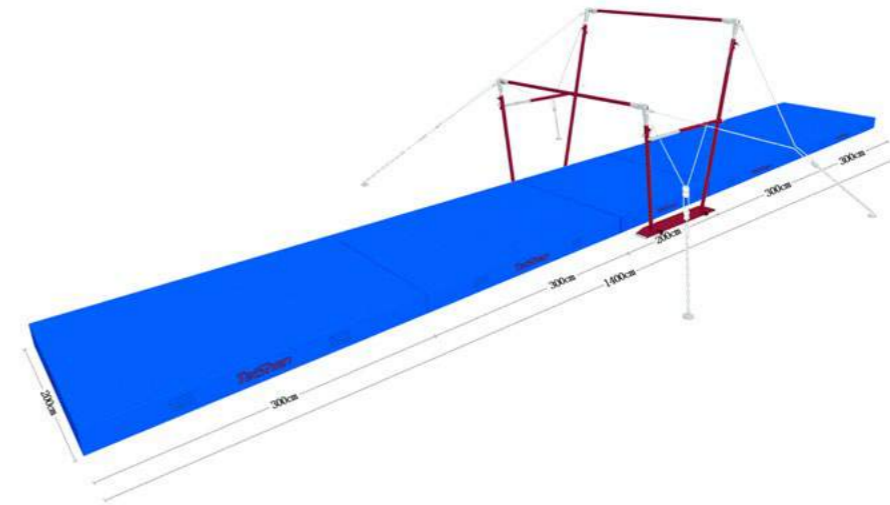

Landing Mats for Uneven Bars  
(training type)

Model: TQ1503A  
 Specification: 1300cm×200cm×20cm  
 Unit size and quantity:  
 300cm×200cm×20cm (4pcs)  
 200cm×100cm×20cm (1pcs)  
 Total area: 26 m<sup>2</sup>

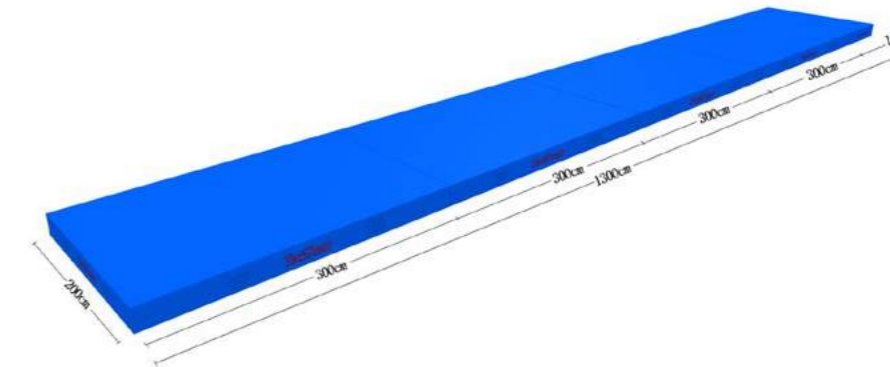

Landing Mats for Balance Beam  
(competition type)



Model: TQ1515A  
 Specification: 1800cm×400cm×20cm  
 Unit size and quantity:  
 200cm×200cm×20cm (1pcs)  
 300cm×200cm×20cm (3pcs)  
 100cm×100cm×20cm (4pcs)  
 250cm×200cm×20cm (4pcs)  
 200cm×100cm×20cm (1pcs)  
 Total area: 48 m<sup>2</sup>

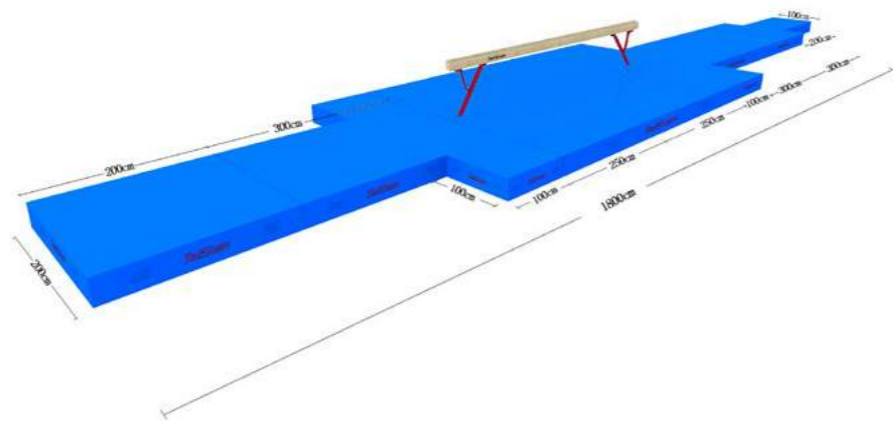

Landing Mats for Balance Beam  
(training type)

Model: TQ1507A  
 Specification: 1700cm×600cm×20cm  
 Unit size and quantity:  
 200cm×300cm×20cm (7pcs)  
 300cm×200cm×40cm (2pcs, foldable)  
 Total area: 66 m<sup>2</sup>

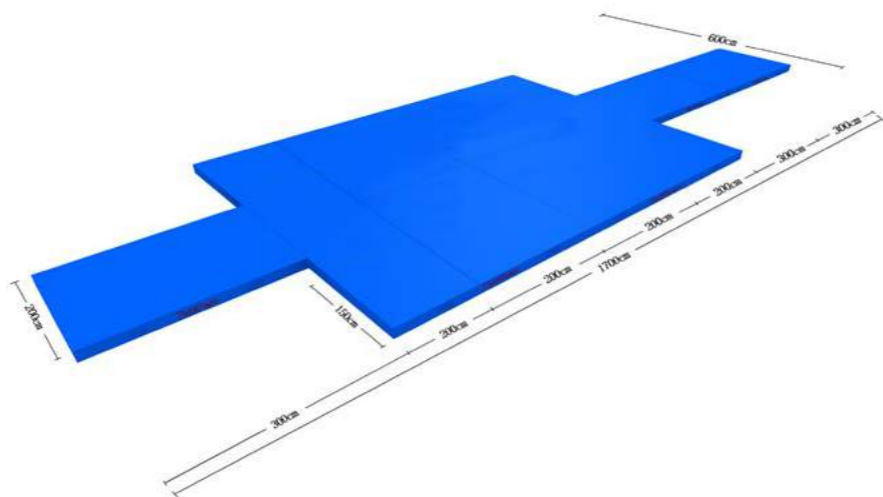

Upper Protection Mats for Trampoline

Model: TQ1564  
 Specification: 940cm×305cm×20cm  
 Unit size and quantity:  
 300cm×200cm×20cm (2pcs)  
 300cm×40cm×16cm (2pcs)  
 201cm×57cm×5cm (2pcs)  
 173cm×57cm×5cm (4pcs, with arc edge)  
 173cm×57cm×5cm (2pcs)  
 Total area: 20 m<sup>2</sup>

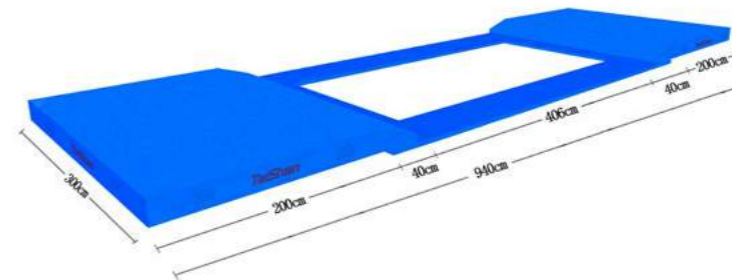

Landing Mats for Trampoline



Model: TQ1556  
 Specification: 1320cm×690cm×20cm  
 Unit size and quantity:  
 200cm×300cm×20cm (8pcs)  
 200cm×290cm×20cm (2pcs)  
 200cm×120cm×20cm (2pcs)  
 Total area: 64.4 m<sup>2</sup>

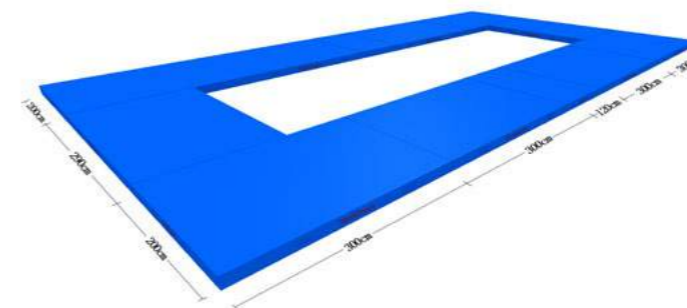

Pitch Mat

Model: TQ2546  
 Specification: 150cm×100cm×14cm  
 Features: The cover material is PVC warp knitting cloth, with good stability, easy installation, comfortable surface, and proper elasticity. Compatible for uneven bars and trampoline.





Supplemental Mats

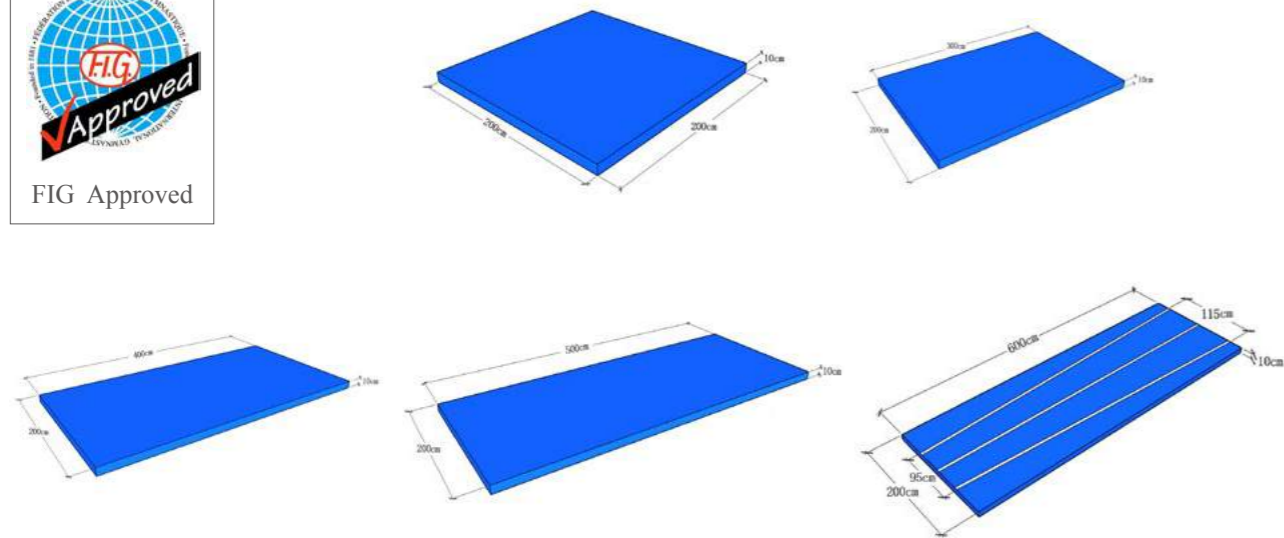

- TQ1525 Supplemental Mat1# 200cm×200cm×10cm compatible for artistic gymnastics.
  - TQ1526 Supplemental Mat2# 200cm×300cm×10cm compatible for artistic gymnastics, rings, beams and parallel bars.
  - TQ1527 Supplemental Mat3# 200cm×400cm×10cm compatible for horizontal bar and beams.
  - TQ1528 Supplemental Mat4# 200cm×500cm×10cm compatible for uneven bars and horizontal bar.
  - TQ1529 Supplemental Mat5# 200cm×600cm×10cm compatible for vaulting horse.
- Features: Made of premium PVC warp knitting cloth and sponge. Lifting handles make it easy to move. With light sponge filled inside, neither too hard, nor too soft. Wear-resistant, water-proof and durable.



Support Block

Model	TQ2616	TQ2696
Specification	50cm×50cm×50cm	90cm×70cm×50cm

(Customized Size is Acceptable)



Men's Gymnastics Pitch

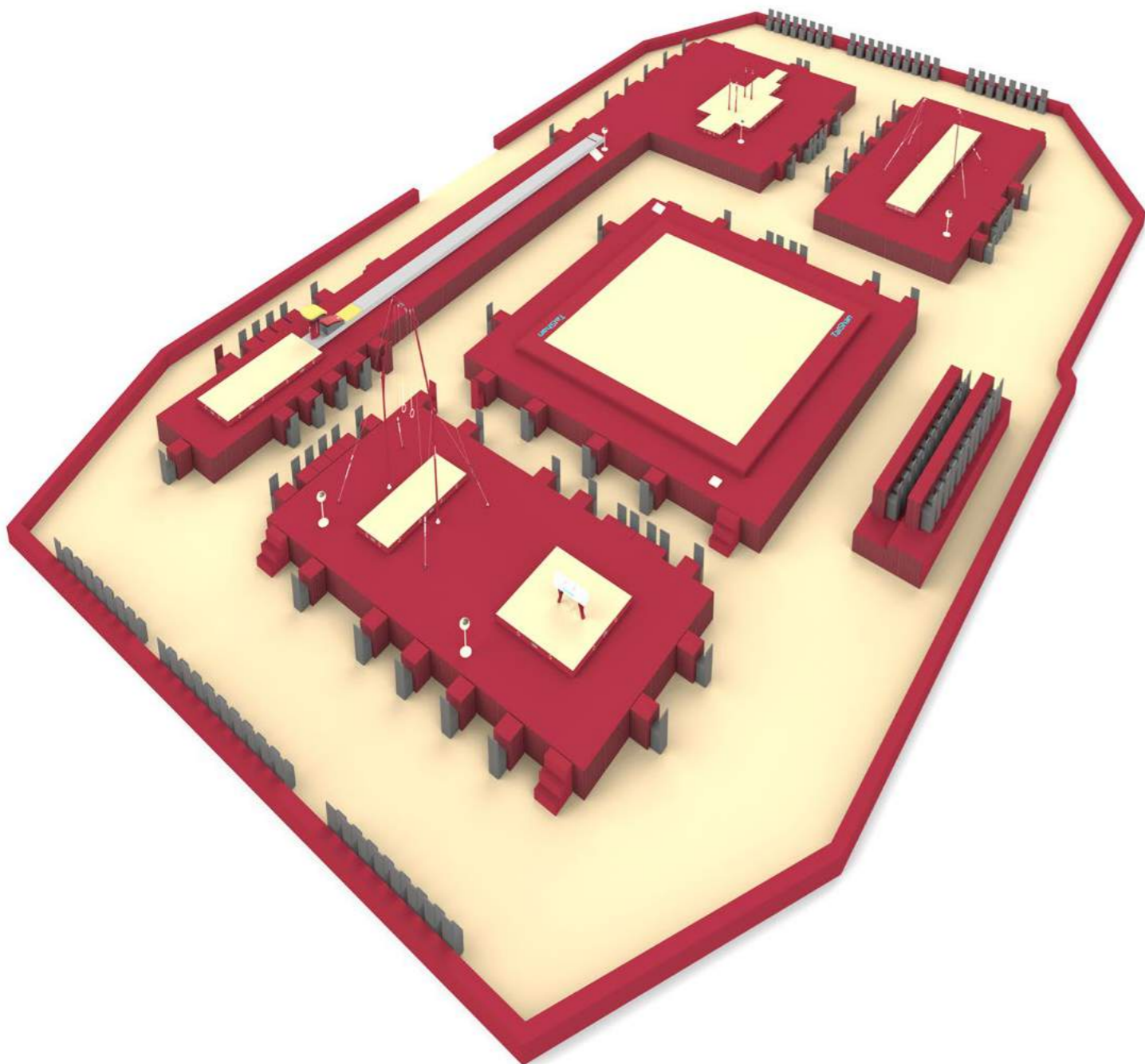

## Competition Equipment for Men's Artistic Gymnastics (including training and warm-up hall)

		Quantity Arena	Quantity warm-up hall	Quantity for each training hall	Remarks
<b>For World Championships and Olympic Games</b>					
<b>Floor Exercise</b>					
Free exercise floor	MAG 1	1	1	1	
Magnesia stand for feet (filled with magnesia)		4	2	2	
Magnesia stand for hands (filled with magnesia)		1	1	1	
Supplementary mat 200x200x10 cm	MAG 13	1)*	2	2	*Only for Podium Training, Warming up session of the Apparatus Finals
<b>Pommel Horse</b>					
Pommel horse (including anchoring system to the floor)	MAG 2	1	2	2	
Set of landing mats 10 cm, surface according to Apparatus Norms	MAG 12	1	2	2	
Magnesia stand for hands (filled with magnesia)		1	2	2	
<b>Rings</b>					
Ring frame	MAG 3	1	1	1	
Set of landing mats 20 cm, surface according to Apparatus Norms	MAG 11	1	1	1	
Ring hook		1	1	1	
Magnesia stand for hands (filled with magnesia)		1	1	1	
Hard foam block approx. 90 x 50 x 70 cm for preparation of the rings		1	1	1	
Supplementary mat 200x200x10 cm	MAG13	1)*	1	1	*Only for Podium Training, Warming up session of the Apparatus Finals
<b>Vault</b>					
Vaulting table (including anchoring system to the floor and 20 cm high padding of the feet)	MAG 4	1	1	1	
Runway with clear markage block at 25 meters		1	1	1	
Set of landing mats 20 cm, surface according to Apparatus Norms	MAG 11	1	1	1	
Supplementary mat 600x200x10 cm with marked landing area (two diverging lines and one central line)	MAG 13	1	1	1	Compulsory use
Soft crash mat 300x200x30 cm			1	1	
Additional supplementary mat 200x200x10 cm	MAG13	1)*	1	1	*Only for Podium Training, Warming up session of the Apparatus Finals
Vaulting board 'hard' (with fixed springs)	MAG 14	1	1	1	
Vaulting board 'soft' (with fixed springs)	MAG 14	1	1	1	
Vaulting board Safety Collar	MAG 15	1	1	1	Compulsory use with round-off vaults
Mat for hands 120x100x3 cm	MAG 16	1	1	1	Use not compulsory
Tape measure 25 meters		1	1	1	
Magnesia stand for feet (filled with magnesia)		1	1	1	
Magnesia stand for hands (filled with magnesia)		1	1	1	
<b>Parallel Bars</b>					
Parallel bars (if necessary with anchoring system to the floor / podium)	MAG 5	1	2	2	
Set of landing mats 20 cm, surface according to Apparatus Norms	MAG 11	1	2	2	
Vaulting board 'soft' (with fixed springs)	MAG 14	1	2	2	
Magnesia stand for hands (filled with magnesia)		1	2	2	
Supplementary mat 200x200x10 cm			2	2	
<b>Horizontal Bar</b>					
Horizontal bar (including anchoring system to the floor)	MAG 6	1	1	1	
Set of landing mats 20 cm, surface according to Apparatus Norms	MAG 11	1	1	1	
Supplementary mat 400x200x10 cm	MAG 13	2	2	2	Compulsory use
Additional supplementary mat 200x200x10 cm	MAG13	1)*	1	1	*Only for Podium Training, Warming up session of the Apparatus Finals
Magnesia stand for hands (filled with magnesia)		1	1	1	
Hard foam block, approx. 50x50x50 cm for preparation of rails		1	1	1	
Dedicated pad for the preparation of the bar		1	1	1	a sufficient number of replacements must be provided

Spare parts such as rails, vaulting boards, pommels etc. at the discretion of the Organiser

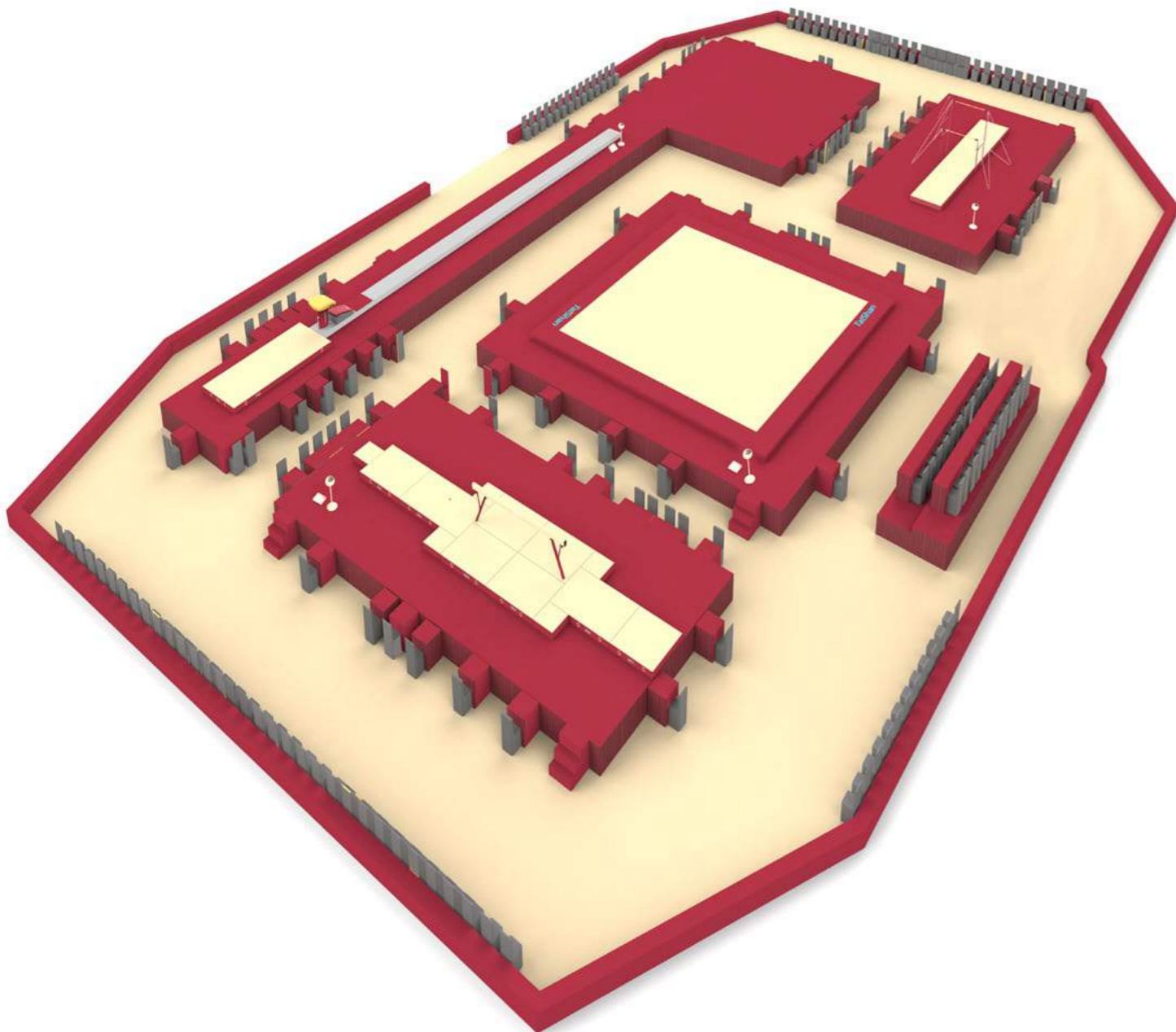

## Competition Equipment for Women's Artistic Gymnastics (including training and warm-up hall)

### For World Championships and Olympic Games

		Quantity Arena	Quantity warm-up hall	Quantity for each training hall	Remarks
<b>Vault</b>					
Vaulting table (including anchoring system to the floor and 20 cm high protection of the feet)	WAG 1	1	1	1	
Set of landing mats 20 cm, surface according to Apparatus Norms	WAG 11	1	1	1	
Runway with clear markage at 25 meters		1	1	1	
Supplementary mat 600x200x10 cm with marked landing area (two diverging lines and one central line)	WAG 13	1	1	1	Compulsory use
Soft crash mat 300x200x30 cm			1	1	
Additional supplementary mat 200x200x10 cm	WAG13	1)*	1	1	)*Only for Podium Training, Warming up session of the Apparatus Finals
Vaulting board 'hard' (with fixed springs)	WAG 14	1	1	1	
Vaulting board 'soft' (with fixed springs)	WAG 14	1	1	1	
Vaulting board Safety Collar	WAG 15	1	1	1	Compulsory use with round-off vaults
Mat for hands 120x100x3 cm	WAG 16	1	1	1	Use not compulsory
Tape measure 25 meters		1	1	1	
Magnesia stand for feet (filled with magnesia)		1	1	1	
Magnesia stand for hands (filled with magnesia)		1	1	1	
<b>Uneven Bars</b>					
Uneven bars	WAG 2	1	2	2	
10 cm support plates		1	1	1	
Set of landing mats 20 cm, surface according to Apparatus Norms	WAG 11	1	2	2	
Supplementary mat, 400x200x10 cm	WAG 13	1	2	2	compulsory use
Additional spotter mat	WAG17	1)*	2	2	)*Only for Podium Training, Warming up session of the Apparatus Finals
Vaulting board 'soft' (with fixed springs)	WAG 14	1	2	2	
Magnesia stand for feet (filled with magnesia)		1	0	0	
Magnesia stand for hands (filled with magnesia)		1	2	2	
Hard foam block, approx. 50x50x50 cm for preparation of rails		1	2	2	
<b>Balance Beam</b>					
Balance beam with padded legs	WAG 3	1	2	2	All knobs and levers padded or removed
Set of landing mats 20 cm, surface according to Apparatus Norms	WAG 11	1	2	2	
Supplementary mat, 400x200x10 cm	WAG 13	1	2	2	Compulsory use
Additional safety mat 200x200x10 cm	WAG13	1)*	2	2	)*Only for Podium Training, Warming up session of the Apparatus Finals
Vaulting board 'soft' (with fixed springs)	WAG 14	1	2	2	
Magnesia stand for feet (filled with magnesia)		1	2	2	
Magnesia stand for hands (filled with magnesia)		1	2	2	
<b>Floor Exercise</b>					
Free exercise floor	WAG 4	1	1	1	
Magnesia stand for feet (filled with magnesia)		4	2	2	
Magnesia stand for hands (filled with magnesia)		2	1	1	
Supplementary mat 200x200x10 cm	WAG13	1)*	2	2	)*Only for Podium Training, Warming up session of the Apparatus Finals

Spare parts such as rails, vaulting board etc. at the discretion of the Organiser

